

EXTERIOR ENCLOSURE

Existing Exterior Enclosure Conditions

The Exterior BOD is intended to be a high-level narrative that is intended to guide design intent as the project develops. It is intended to describe project goals and intent for the exterior upgrades as it relates to concepts and strategies for envelope upgrades, thermal and moisture mitigation and exterior vertical circulation.

The existing Stewart Building was originally dedicated in 1925 and has historical significance as indicated by the California State Historic Preservation Office. The existing building is a 2-story structure that consists of wood-framed construction with reinforced concrete bearing walls. The existing main and high roof consists of s-shaped clay tiles that line the perimeter and asphalt shingles and panels at the remainder of the roof. The original window openings/frames need replacement and must be replaced in kind due to their historical significance.

Proposed Exterior Enclosure

Exterior Skin

The existing exterior envelope will be maintained due to its historical significance. The interior side of the exterior walls will require performance-based envelope upgrades. Envelope enclosure upgrades will consist of maintaining the existing exterior cement plaster wall substrate to include repairs and repainting and providing new code required, energy-drive performance-based upgrades at the interior side of the exterior wall assembly. All existing exterior opening locations will be maintained with in-kind upgrades to openings; new openings will be created and existing openings will be infilled to align with required envelope upgrades and match the existing façade.

Exterior Glazing

The original windows and frames at existing openings will need to be upgraded, in kind due to the historic significance of the building, to meet current code requirements for energy performance.

Exterior glazing is assumed to be high-performance, thermally broken, insulated glazing units.

Thermal and Moisture Protection

- The existing building exterior envelope will need to be evaluated and upgraded at the interior side of the envelope for thermal upgrades.
- Existing cement plaster walls to be inspected, cleaned, repaired, and painted.
- All infill construction and existing openings to be sealed and weather gasketed.
- Where new trenching work is required for plumbing and fire protection systems at grade within the building, new waterproofing measures are to be provided.

Flooring and Roofing

The existing 2-story wood-framed structure currently consists of straight sheathing over 1x8 diagonal sheathing, supported on 2x joists at 16" OC at the second floor and concrete slab-on-grade at the ground floor. On the ground floor, the proposed upgrades would include maintaining the existing concrete slab-on-grade, demolishing the existing ramping, and excavating down at higher grade areas to align with the lower grade areas. Where concrete is to remain exposed in public facing areas and existing cracking is present, the repairs will need to be performed by either filling or injecting the cracks with epoxy or polyurethane filler. The slab would be finished with epoxy coating to conceal the crack repair and lessen dust buildup. An alternative option would be to clear seal concrete in lieu of epoxy finish. At level 2, anticipate, new structural reinforcement for the existing floor joist system.

The existing roofing membrane system is intended to be replaced, with system(s) to be determined. Existing gutters, downspouts and water shedding systems are to be replaced. Where existing ornamentation is present at existing water shedding systems, replacement in kind is to be evaluated and anticipated.

Roof Edge Protection Systems

Basis of Design Ballasted Roof Railing System – TBD

Existing Exterior Stairways

Existing Exterior Egress Stair (Main Entry-South Side of Building)

- The existing exterior egress stair will need to be evaluated for compliance. If it were deemed to be non-compliant, the stair will more than likely be demolished and reconstructed in place with a new code-compliant egress stair pending structural review.
 - Basis of Design – Cast in place concrete stair of similar design. Paint color to be determined by the architect.
 - Basis of Design Alternate - Reusing existing stairs and refurbishing treads, replace handrails and guardrail where applicable and required. Stair to be painted with paint color to be determined by the Architect.

Existing Exterior Stair and Ramp (East Side of Building)

- The existing exterior stair and ramp will need to be evaluated for compliance. If they were deemed to be non-compliant, the stair and ramp will more than likely be demolished and reconstructed in place with a new code-compliant egress stair and ramp, pending structural review.
 - Basis of Design – Cast in place concrete stair and ramp of similar design. Paint color to be determined by the architect.
 - Basis of Design Alternate (pending compliance) - Reusing existing stairs and ramp and refurbishing treads, replace handrails and guardrail where applicable and required. Stair and ramp to be painted with paint color to be determined by the Architect.

Exterior Openings

Basis of Design Glass Roll-up Sectional Doors:

- Commercial Door Company Inc. – Integration to be determined upon field verification of existing at grade conditions for use at the Ambulance Simulation Lab. - TBD

Basis of Design Storefront Systems (Primary Entry Points):

- Kawneer Trifab VersaGlaze 451/451T

Basis of Design Hollow Metal Doors and Frames (BOH Spaces):

- Assa Abloy Curries line, 707 series or equivalent

Basis of Design Louvers

Ruskin Acoustical Louvers

Mechanical / Utility Screens

Basis of Design Mechanical Screen:

- Morin Roof Systems (Kingspan) – TBD, pending mechanical equipment location

Basis of Design Trash Enclosure (anticipate no roof at enclosure, walls and gates only)

- Integral water repellent, reinforced CMU
- Steel gates – Ametco

Exterior Lighting

Existing exterior building lighting and site lighting are to be replaced and supplemented with new where required and evaluated from a code and safety standpoint. Where ornamentation is present at existing lighting, replacement in kind is to be evaluated and anticipated.

Site Protection Systems

Site Bollard System – TBD

Site Elements

- Landscaping: Anticipate removal and/or replacement of trees, bushes and shrubs particularly where landscaping is overgrown at the building dripline.
- Parking Lot: Anticipate parking lot resurfacing, striping to include accessible parking and paths of travel.

- Site Electrical Utilities: The existing building has multiple meters at the exterior of the building that will need to be evaluated for consolidation.
- Electronic safety and security: Anticipate the addition of site cameras along the building perimeter and around the site. The security systems will use the California State University Technology Infrastructure Planning (TIP) standards (v5.1) design criteria and will be coordinated closely with University security personnel and campus Police. Coordination should be provided with State Representatives throughout the design and construction process to implement system programming, establishing the operational parameters for the security systems, and complying with standardized campus practices.

INTERIORS

Proposed Interiors

The Interior BOD is intended to be a high-level design narrative that will be used for direction as the project develops and is intended to describe project goals and intent for the interiors. It provides a guide and overview of our approach as it relates to concepts and strategies for materiality, lighting, wayfinding, relative to the building interior environment.

The main goal is to create a timeless design with a cost-effective solution. The interior design will incorporate meaningful and elegant applications of interior architecture and use of finishes with consideration of aesthetics, cost/value, quality, longevity, safety, and sustainability. Differentiating between public spaces, shared staff/student areas, and support spaces will be reinforced through the use of similar materials, finishes, and products with a sensitivity to costs and appropriateness.

Partition Systems

In the existing building, interior partitions will be 5/8-inch gypsum board on 6-inch steel studs with acoustic batt insulation. 6" steel stud partitions will be supported in a metal stud framed structural box system atop 8-inch-deep metal stud joists with a plywood top (10" deep steel studs joists where span is greater than 25'-0"). Partitions system extend to approximately 13'-0" AFF.

Interior Glazing

Interior glazed partitions will be tempered glass system with prefinished aluminum frames with intermediate mullions.

Basis of Design Interior Storefront – Kawneer Trifab VersaGlaze 450 Framing System 1-3/4" Sitrline – center flush glazed, non-thermal break type system, for half-inch thick glass.

Doors and Hardware

Interior doors to be hollow metal with hollow metal frames.

- Offices and Conference Rooms – Doors to be solid wood with corresponding sidelite.
- Classrooms – Doors to have full glass with corresponding sidelite.

Glass will be 1/2-inch thick clear laminated glass in hollow metal door/frame.

Door hardware will be lever handle or push type, except where panic hardware is required. Security hardware will be provided and to be determined based on facility needs. Assume automatic operators at entry doors on the accessible path of travel and card readers at exterior doors, instructional teaching spaces, lab, storage, office and BOH spaces as a minimum. As indicated in the project description, the use of a fire sprinkler system is the primary basis of design with no use of a fire sprinkler system as an alternative option pending the University's fire flow test results. Where fire doors are required, such doors shall be self- or automatic closing. Assume fire doors to be provided with magnet hold-open hardware.

Access Panels / Hatches will be required for utility access.

Window Treatment

All exterior glazing in classrooms and occupied rooms, select interior glazing to receive mechanized rolldown shade window treatment coverings and/or window film.

Basis of Design Interior Window Mechanized Shades –Mecho Shade Systems - Provide blackout shades at all rooms with projection.

Basis of Design Interior Window Film –3M Glass Film – Privacy film / safety film at select locations, TBD

Stairways

Existing Interior Egress Stair

- The existing west interior egress stair will be demolished and reconstructed with a new code-compliant egress stair with a new floor opening at new location on west side of building.
 - Basis of Design – Prefabricated, painted steel stair with concrete treads. Paint color to be determined by the architect.
- The east interior stair will be removed and floor opening will be filled in.

Ceiling Systems

General Ceiling Finishes

- Level 1 and 2 Ceilings - Common corridors will have painted level 4 gypsum board finish ceilings.
- Acoustic Ceiling Panels
 - To be applied in gathering spaces with exposed ceilings, generally where open seating is shown in corridors or whereas indicated in the acoustical narrative.
 - Basis of Design: USG - color and pattern to be selected by Architect.
 - Alternate Basis of Design: Rockfon - color and pattern to be selected by Architect.

Floor and Wall Systems

General Wall and Floor Finishes

- Level 1 Flooring – Resilient sheet flooring; concrete floor will be repaired and leveled
- Level 2 Flooring - Common corridors have existing wood flooring. Repair and refurbish. Insulate the underside of the floor for footfall (recommended acoustics).
 - Alternate: Resilient sheet flooring
- Gypsum Wall Finish - Level 1 and 2 public spaces to have level 4 gypsum board finish.
- Interior Painting – Field applied paint on all gypsum assemblies. Colors to be selected by Architect.
- Acoustic Wall Panels (reference room data sheets in appendix for applicable areas).
 - For spaces not called out in the room data sheets, acoustic wall panels to be generally applied in lobbies and gathering spaces with exposed ceilings or whereas indicated in the acoustical narrative.
 - Basis of Design – Armstrong Acoustic Wall Panels - color and pattern to be selected by Architect.
 - Alternate Basis of Design – ASI Architectural - color and pattern to be selected by Architect.

Operable Partition System

- A manual horizontal operation partition system will be provided as the demising wall between the two medium classrooms located in the central volume.
 - Basis of Design – Modernfold – paired panels, bifold hinge, finish/color to be determined by Architect.

General Interior

Reference room data sheets in appendix for the following program areas:

- Breakrooms/Lounges
- Classrooms
- Conference Rooms
- Copy Rooms
- Labs
- Lab Support Spaces
- Offices

Lobby / Open Gather Spaces

- Level 4 gypsum board finish
- Suspended acoustic ceiling at reception and seating areas.
- Accent feature lighting

Janitor / Storage and Support Spaces

- Level 1 and 2 – Resilient sheet flooring and cove base. Epoxy wall paint.
- Wire storage shelving at Janitor rooms with janitors sink.

- Wall Protection in wet areas

Wellness Room

- Carpet tile with rubber base throughout.
- Gypsum board ceiling
- Plastic Laminate casework (color to be determined by the Architect)
- Solid surface sink, counters and backsplash

Gender Neutral Multi-Occupant Toilet Room / Gender Neutral Single-Occupant Toilet Room

- In multi-occupant gender neutral toilet room provide full-height toilet compartments. Basis of Design toilet compartments: Bobrick DuraLine Series CGL 1080/3086G
- Provide wall hung lavatories and water closets. Basis of Design Plumbing Fixtures: Sloan
- Install automatic flush valves on toilets.
- Wet walls basis of design to be porcelain tile, alternate to be wall protection.
- Floor basis of design to be porcelain tile (possibly resilient on Level 2)
- Provide wall hung ADA compliant mirror.
- Provide toilet dispensers / accessories.
- Provide overhead lighting and exhaust.
- Provide 2 drinking fountains / bottle filler outside of Level 1 & Level 2 gender-neutral multi-occupant toilet room.

Back of House Spaces (BOH)

- To include mechanical rooms, electrical rooms, IDF/MDF rooms and AV rooms
- Floor – Resilient flooring, rubber base
- Walls – Level 2 gypsum board finish or existing exposed concrete, Electrical / Data rooms to have $\frac{3}{4}$ " fire treated plywood attached to gypsum board on all walls.

Specialties

- Specialties, including restroom specialties, wall protection, marker boards, tackable surfaces, lockers, display cases, screens, signage, fire extinguishers, etc.
- Assume semi-recessed fire extinguisher cabinets with max spacing of 150' between, capable of holding a multipurpose dry-chemical type, extinguisher in steel container. 10 lb. nominal capacity. At these locations 6" studs will be required.

Casework

- Construct in accordance with Premium Grade of the Architectural Woodwork Standards, latest edition unless otherwise specified herein.
- Full overlay style, rigid and self-supporting cabinets suitable for use in an assembly or as individual, stand-alone units, with joints securely glued and cabinets clamped under pressure during assembly to ensure secure joints and cabinet squareness. Joints: Doweled and glued or mortised and tenoned secured with glue and countersunk screws.

- Square edged door and drawer fronts overlapping the openings on all four sides. In elevation, hold the reveal between end panel and door or drawer edge to a maximum of 1/8 inch wide. Hold spaces between abutting doors and drawers to a maximum of 1/8 inch wide, both horizontally and vertically, and shall be accurate and uniform, forming a continuous reveal throughout full length of assembled casework. Hold the reveal between top of cabinet and door or drawer edge to a maximum of 1/4 inch wide. Trim and sand smooth with all edges and corners radiused.
- Species:
 - Exposed and Semi-Exposed Surfaces: To be determined by Architect
 - Concealed Surfaces: Plain sliced hardwood veneer, suitable for unexposed surfaces.
- Grain Direction:
 - Vertical matched grain direction on cabinet drawer heads, doors, end panels, KO panels, KO aprons, table aprons, and filler panels.
- Color and Matching Selection:
 - Compatible in color with solid stock and well matched in color and grain with adjacent plywood panels.
 - Hand select plywood prior to fabrication of cabinet faces for uniformity of color and grain on each run of bench. Darker and lighter panels are not acceptable in the same run of bench or same room after installation of casework.
- Cores:
 - Veneer: One piece hardwood solid core with crossbanding and hardwood face veneers. Minimum 9 ply for 1 inch, 7 ply for 3/4 inch, 5 ply for 1/2 inch, and 3 ply for 1/4 inch.
 - Combination with composite crossbands: Minimum 7 ply for 3/4 inch (19 mm). One piece hardwood solid core with two hardwood solid and two MDF crossbands and hardwood face veneers. MDF crossbands under face veneers.
- Alternate: Miller Knoll pre-fabricated solutions - Mora or Compass System

CONVEYING SYSTEMS

Elevators

1 passenger/service elevator, 4500 lb. at 150 fpm, machine-room-less electric traction elevator with 42-inch single speed side opening door.

- Elevator will serve all staff, students and visitors.

FUTURE WORK (Phase 2)

Proposed Future Expansion

The following spaces are listed below for future expansion, unless if budget allows it to be included for initial build-out. These spaces will be shelled out and finishes on walls and floors will be determined. Refer to "Program Summary" for more detail.

Instructional Labs – Clinical Skills

- Testing Facility – Qty: 1

Clinical Exam (Outpatient)

- Intake Room (Debrief #1) – Qty: 1
- Exam Room / VR (Primary Care) – Qty: 3
- Exam Room (Large) – Qty: 1
- Brief / Debrief (#2) – Qty: 1
- Control Room (Specialty/SP) – Qty: 1

Immersive Simulation (Inpatient)

- High Fidelity Simulation Lab – Qty: 2
- High Fidelity Simulation Lab (Large) – Qty: 1
- Control Room – Qty: 3
- Brief / Debrief (#3) – Qty: 1

Occupiable Gross Square Footage per campus Fac Link			41,781
Useable Square Footage per Campus Fac Link			29,516
Assignable Square Footage from Program below (excluding Back of house spaces)			19,360
Building Efficiency Factor			0.46

Areas shown in ORANGE Text below are considered here for future build-out.

	Space Name	ASF per Room	Number of Rooms	Total ASF
	January 2025 Program excluding back of house space			19,360
	Existing Building Target GSF			41,781
	Efficiency Factor			0.46
100	CLASSROOMS			4,440
	Classrooms			4,440
	Classroom - Large / Medium	1,500	2	3,000
	Classroom - Small	720	2	1,440
200	INSTRUCTIONAL LABS			11,720
	Instructional Labs - Clinical Skills			4,990
	Skills Lab	1,920	1	1,920
	Assessment Lab	1,920	1	1,920
	Testing Facility	550	1	550
	Support/Storage	600	1	600
	Instructional Labs - Applied Health			1,600
	Lab - Exercise Space/ Testing	300	1	300
	Lab - Fall Prevention / Multipurpose Space	1,000	1	1,000
	Storage	300	1	300
	Instructional Labs - EMT			850
	Lab Space & Ambulance Simulation garage/bay	600	1	600
	Storage	250	1	250
	Clinical Exam (Outpatient)			1,080
	Intake Room (Debrief #1)	250	1	250
	Exam Room / VR (primary care)	110	3	330
	Exam Room (large)	150	1	150
	Brief / Debrief (#2)	250	1	250
	Control Rm (Specialty/SP)	100	1	100
	Immersive Simulation (Inpatient)			3,200
	High Fidelity Simulation Lab	275	1	275
	High Fidelity Simulation Lab	275	1	275
	High Fidelity Simulation Lab	400	1	400
	Mixed Reality VR Black Box	200	1	200
	Maker/Moulage	300	1	300
	Activities of Daily Living	600	1	600
	Control	100	3	300
	Brief / Debrief (#3)	250	1	250
	Storage & Laundry	600	1	600
300	OFFICE			1,830
	Workplace			1,830
	Director Offices	165	2	330
	Admin Offices	90	2	180
	Shared Office (Hotelling) -	90	6	540
	Sim Opps Manager	100	1	100
	Sim Opps Shared Workspace	300	1	300
	Staff lounge	300	1	300
	Work Room - Copier/Storage	80	1	80
600	GENERAL USE			1,370
	Reception			890
	Reception	100	1	100
	Lobby / Reception	300	1	300
	Breakroom/Lounge	400	1	400
	Wellness / Lactation	90	1	90
	Assembly/Meeting			480
	Large Conference Room	300	1	300
	Medium Conference Room	240	1	240
	Small Meeting Rooms/ Huddle	120	2	240
	General Support (Back of House spaces)			4,660
	Air/vacuum	150	1	150
	AV rack room	200	1	200
	JAN	80	3	240
	ELEC	500	1	500
	MECH	1,500	1	2,000
	IDF	120	3	360
	MDF	120	1	120
	Single Occ Toilet	80	3	240
	All-Gender Toilet	850	1	850

Note: Future Work (Phase 2) in orange

CODE	CLRM-01, CLRM-02
DESCRIPTION	CLASSROOM MED/LRG
DEPARTMENT	CLASSROOM
SPACE TYPE	CLASSROOM
GENERAL	
PROGRAM AREA (NSF)	1500 SF
ACTUAL AREA (NSF)	1220 SF
PROGRAMED SEAT COUNT	50
FLOOR LOADING	
ACCESS	
ACOUSTICS	STC 50
SIGNAGE / WAYFINDING	
ELECTRONIC SECURITY	
SAFETY CONCERNS	
FINISHES (SEE PLANS)	
FLOORING	RESILIENT FLOORING (RF)
WALLS	PAINT (PT), ACOUSTIC FABRIC WRAPPED PANEL (FWP)
CEILING	ACOUSTIC TILE CEILING (CLG - ACT) & GYPSUM CEILING (CLG-GYP)
TECHNOLOGY REQMT	
EQUIPMENT, NETWORK, COMMUNICATIONS	
UTILITIES REQMT	
HVAC	
ELECTRICAL	
ELECTRIC LIGHT	RECESSED BAFFLED LINEAR AREA LIGHTING, RECESSED LINEAR WALL WASH
PLUMBING	
ADD. REQUIREMENTS	
	TOTAL QTY: (2)

*Indicates items will not be part of the project Base pricing, listed for planning and design purposes ONLY.

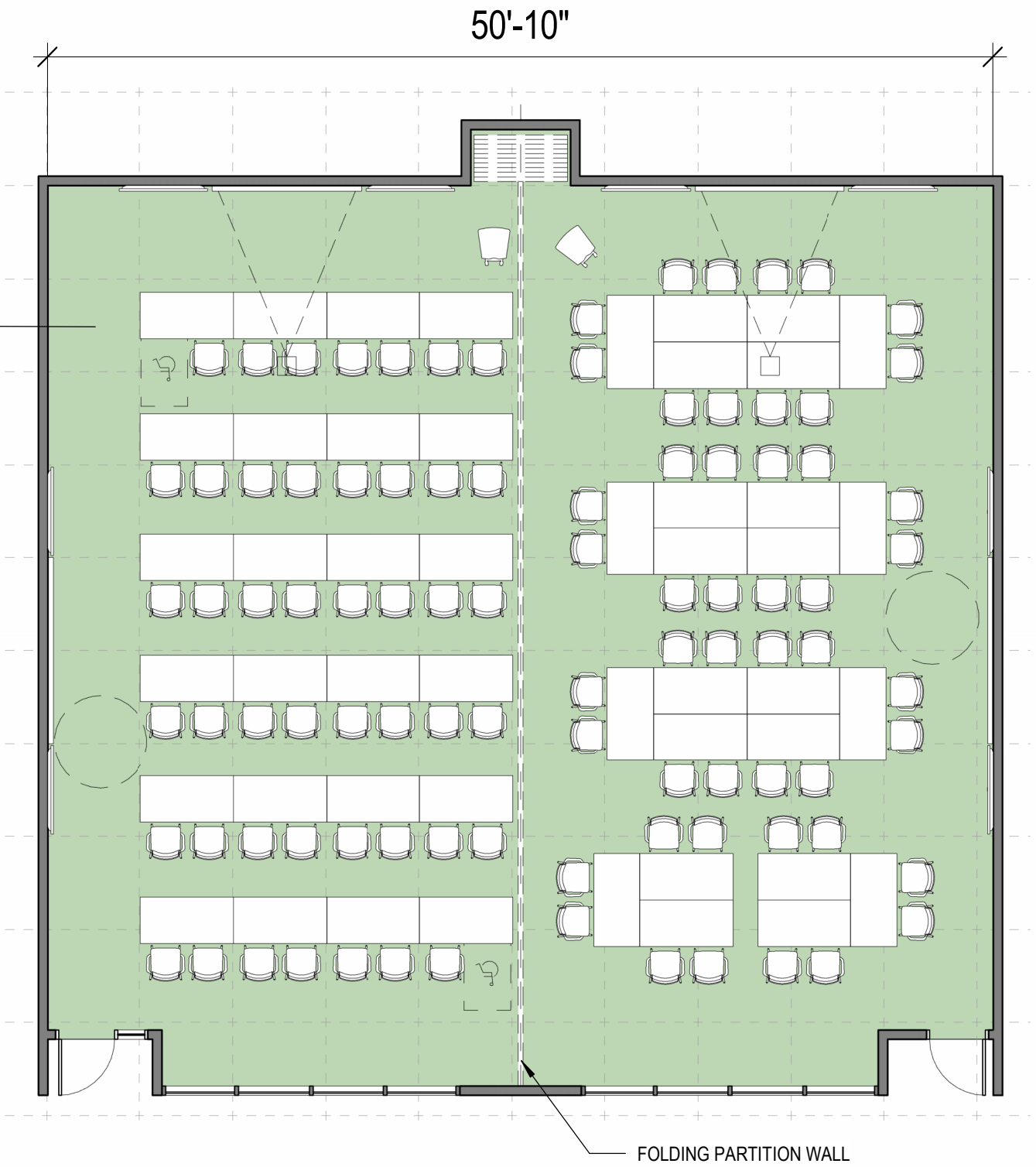

1 CLASSROOM MED/LRG PLAN
SCALE: 1/8" = 1'-0"

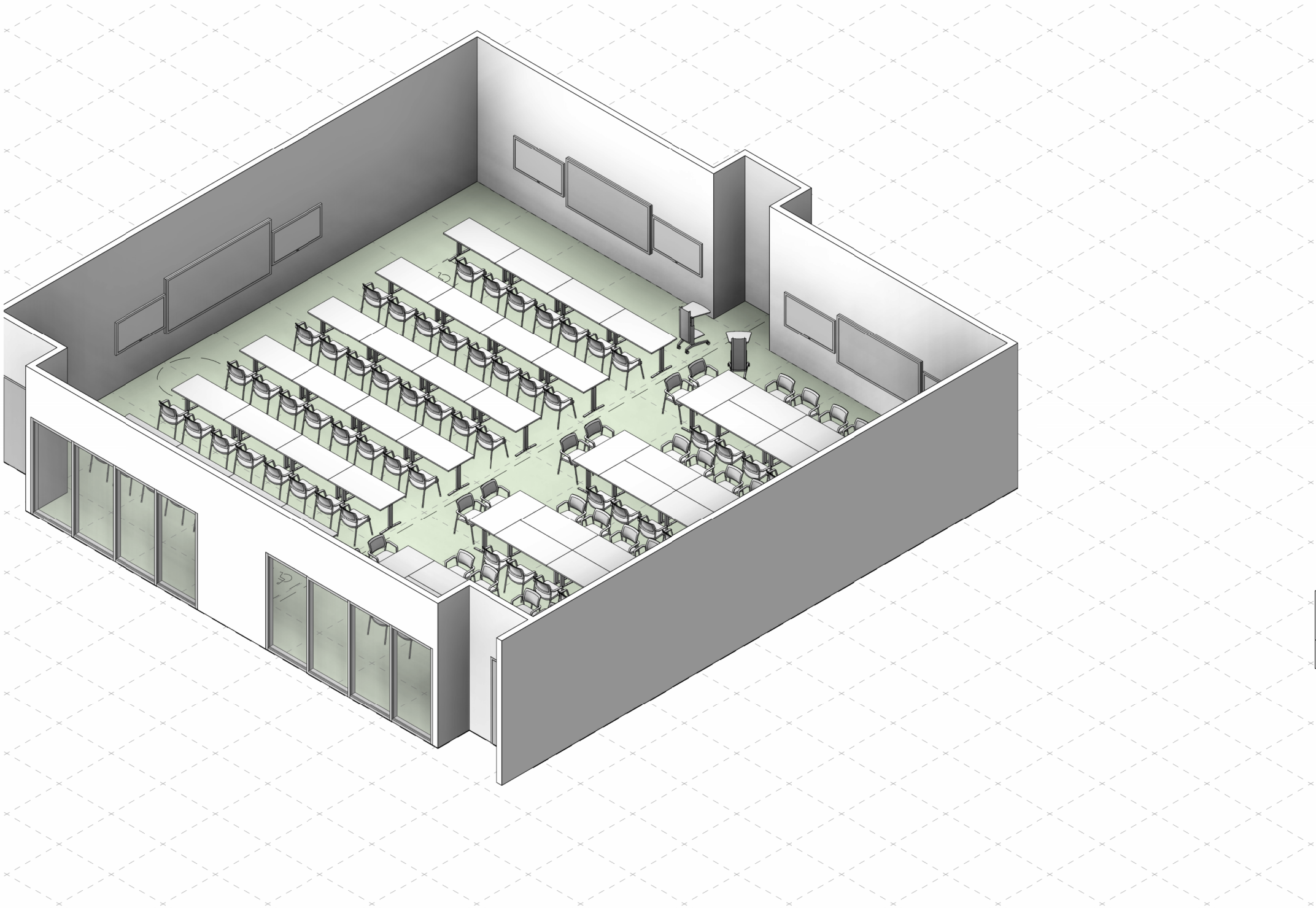

FFE Schedule - CLASSROOM MED/LRG		
FURNITURE FURNISHING AND EQUIPMENT TYPE	DESCRIPTION	COUNT

Furniture Schedule - CLASSROOM MED/LRG
Furniture Seat Count

1

3D - CLASSROOM MED/LRG

SCALE:

CODE	CLRM-03, CLRM-04
DESCRIPTION	CLASSROOM SMALL
DEPARTMENT	CLASSROOM
SPACE TYPE	CLASSROOM
GENERAL	
PROGRAM AREA (NSF)	720 SF
ACTUAL AREA. (NSF)	707 SF
PROGRAMED SEAT COUNT	24
FLOOR LOADING	
ACCESS	
ACOUSTICS	
SIGNAGE / WAYFINDING	
ELECTRONIC SECURITY	
SAFETY CONCERNS	
FINISHES (SEE PLANS)	
FLOORING	CARPET (CPT)
WALLS	PAINT (PT), ACOUSTIC FABRIC WRAPPED PANEL (FWP)
CEILING	ACOUSTIC TILE CEILING (CLG - ACT)
TECHNOLOGY REQMT	
EQUIPMENT, NETWORK, COMMUNICATIONS	
UTILITIES REQMT	
HVAC	
ELECTRICAL	
ELECTRIC LIGHT	PENDANT MOUNTED BAFFLED LINEAR DIRECT/INDIRECT AREA LIGHTING, RECESSED LINEAR WALL WASH
PLUMBING	
ADD. REQUIREMENTS	
TOTAL QTY: (2)	

*Indicates items will not be part of the project Base pricing, listed for planning and design purposes ONLY.

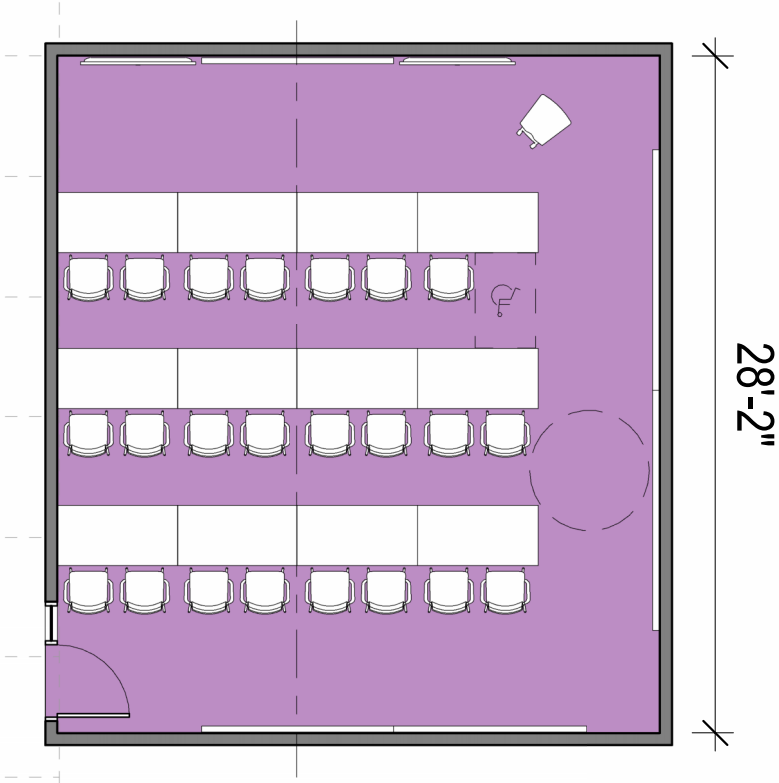

1 CLASSROOM SMALL PLAN
SCALE: 1/8" = 1'-0"

FFE Schedule - CLASSROOM SMALL			Furniture Schedule - CLASSROOM SMALL
FURNITURE FURNISHING AND EQUIPMENT TYPE	DESCRIPTION	COUNT	Furniture Seat Count

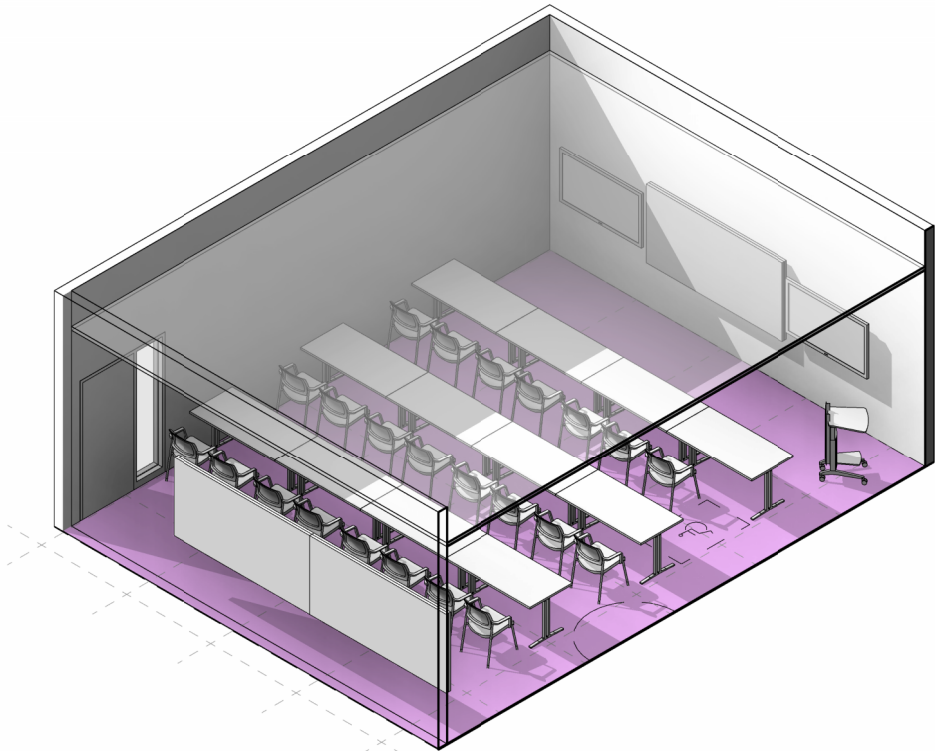

3 3D - CLASSROOM SMALL
SCALE:

CODE	SKL.LAB-01, SKL.LAB-02
DESCRIPTION	SKILLS LAB
DEPARTMENT	INSTRUCTIONAL LAB
SPACE TYPE	INSTRUCTIONAL LAB - CLINICAL SKILLS
GENERAL	
PROGRAM AREA (NSF)	1920 SF
ACTUAL AREA. (NSF)	1560 SF
PROGRAMED SEAT COUNT	32
FLOOR LOADING	
ACCESS	
ACOUSTICS	
SIGNAGE / WAYFINDING	
ELECTRONIC SECURITY	
SAFETY CONCERNS	
FINISHES (SEE PLANS)	
FLOORING	RESILIENT FLOORING (RF)
WALLS	PAINT (PT), WALL PROTECTION - RIGID SHEET (WP)
CEILING	ACOUSTIC TILE CEILING (CLG - ACT) & GYPSUM CEILING (CLG-GYP)
TECHNOLOGY REQMT	
EQUIPMENT, NETWORK, COMMUNICATIONS	
UTILITIES REQMT	
HVAC	
ELECTRICAL	
ELECTRIC LIGHT	RECESSED LENSED 1X4 IN RECTANGULAR CONFIGURATION
PLUMBING	
ADD. REQUIREMENTS	
TOTAL QTY: (2)	

*Indicates items will not be part of the project Base pricing, listed for planning and design purposes ONLY.

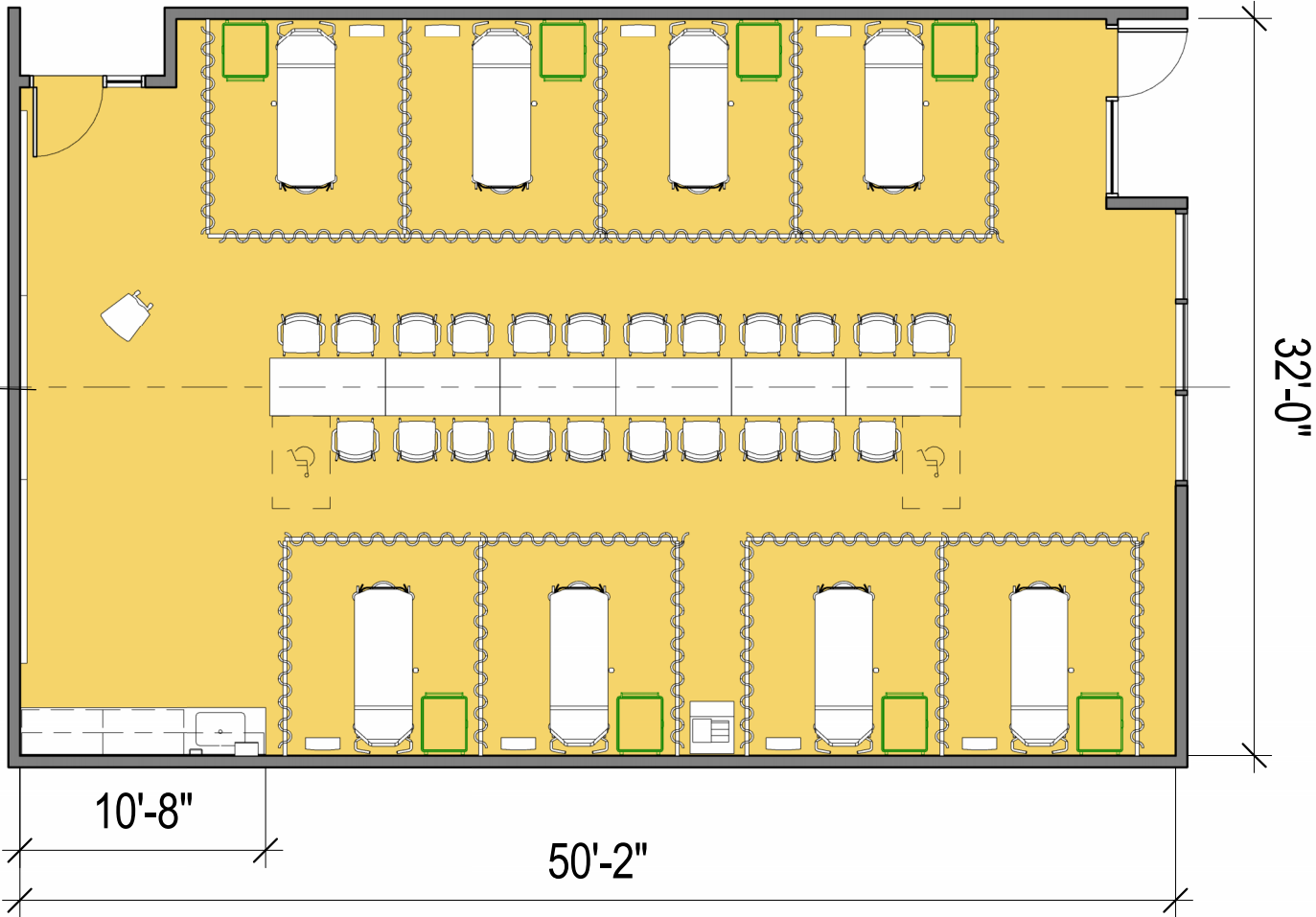

1 SKILLS LAB PLAN
SCALE: 1/8" = 1'-0"

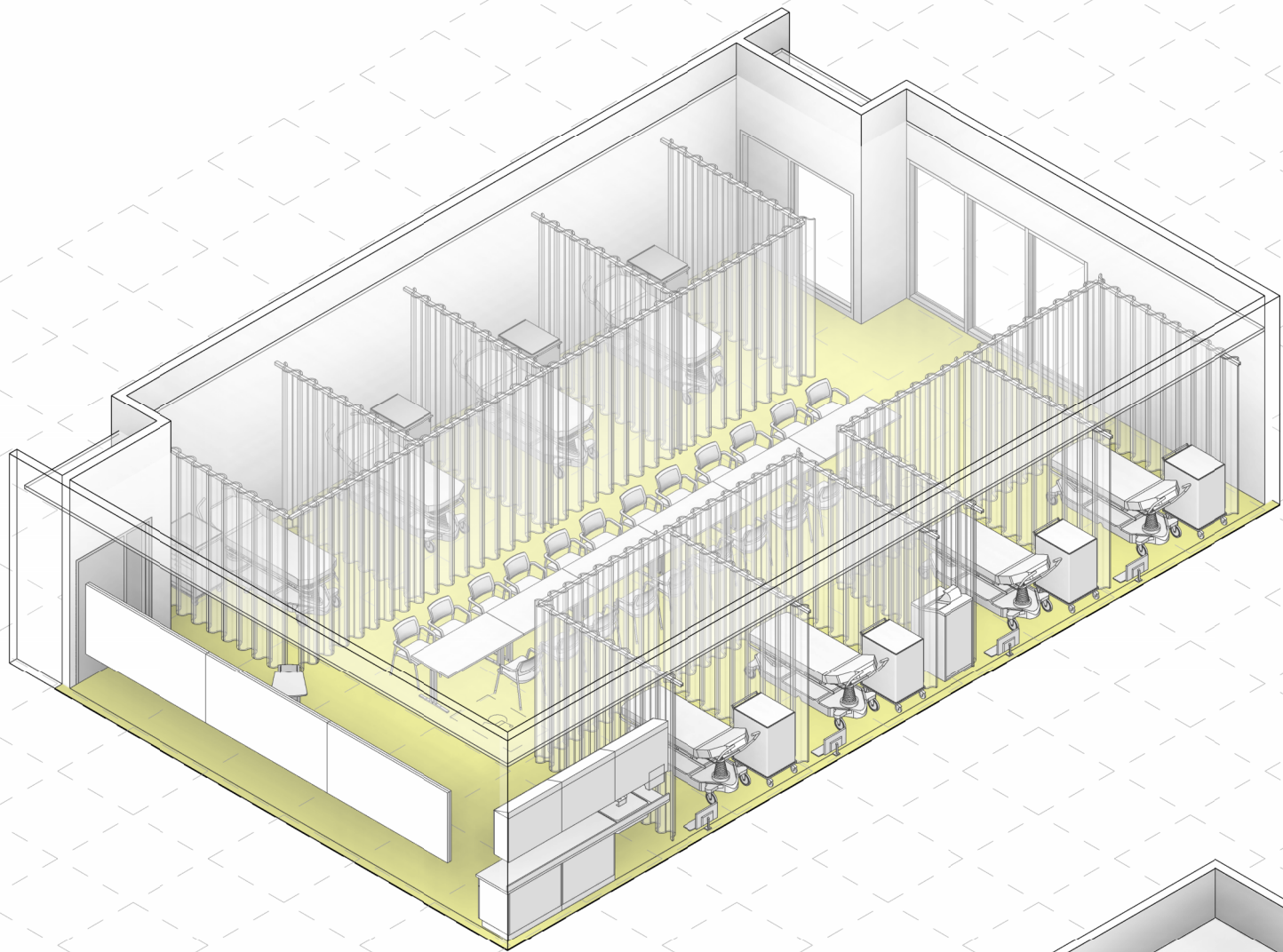

FFE Schedule - SKILLS LAB		
FURNITURE FURNISHING AND EQUIPMENT TYPE	DESCRIPTION	COUNT

1 3D - SKILLS LAB
SCALE:

CODE	ASM.LAB-01
DESCRIPTION	ASSESSMENT LAB
DEPARTMENT	INSTRUCTIONAL LAB
SPACE TYPE	INSTRUCTIONAL LAB - CLINICAL SKILLS
GENERAL	
PROGRAM AREA (NSF)	1920 SF
ACTUAL AREA (NSF)	1537 SF
PROGRAMED SEAT COUNT	32
FLOOR LOADING	
ACCESS	
ACOUSTICS	
SIGNAGE / WAYFINDING	
ELECTRONIC SECURITY	
SAFETY CONCERNS	
FINISHES (SEE PLANS)	
FLOORING	RESILIENT FLOORING (RF)
WALLS	PAINT (PT), WALL PROTECTION - RIGID SHEET (WP)
CEILING	ACOUSTIC TILE CEILING (CLG - ACT) & GYPSUM CEILING (CLG-GYP)
TECHNOLOGY REQMT	
EQUIPMENT, NETWORK, COMMUNICATIONS	
UTILITIES REQMT	
HVAC	
ELECTRICAL	
ELECTRIC LIGHT	RECESSED LENSED 1X4 IN RECTANGULAR CONFIGURATION
PLUMBING	
ADD. REQUIREMENTS	
	TOTAL QTY: (1)

*Indicates items will not be part of the project Base pricing, listed for planning and design purposes ONLY.

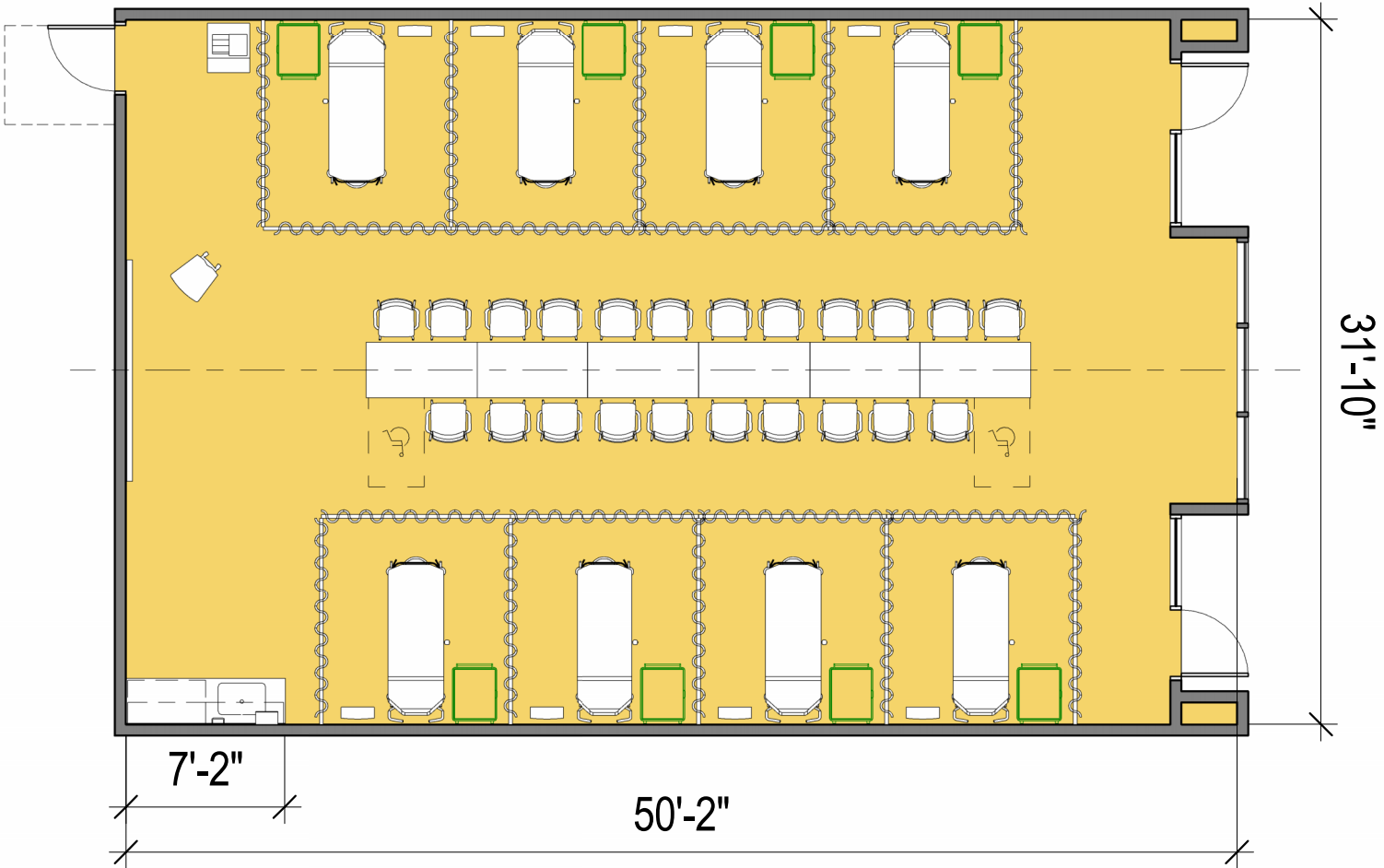

1 ASSESSMENT LAB PLAN
SCALE: 1/8" = 1'-0"

CODE	TEST
DESCRIPTION	TESTING
DEPARTMENT	
SPACE TYPE	
GENERAL	
PROGRAM AREA (NSF)	530 SF
ACTUAL AREA. (NSF)	450 SF
PROGRAMED SEAT COUNT	
FLOOR LOADING	
ACCESS	
ACOUSTICS	
SIGNAGE / WAYFINDING	
ELECTRONIC SECURITY	
SAFETY CONCERNS	
FINISHES (SEE PLANS)	
FLOORING	RESILIENT FLOORING (RF)
WALLS	PAINT (PT), WALL PROTECTION - RIGID SHEET (WP)
CEILING	ACOUSTIC TILE CEILING (CLG - ACT) & GYPSUM CEILING (CLG-GYP)
TECHNOLOGY REQMT	
EQUIPMENT, NETWORK, COMMUNICATIONS	
UTILITIES REQMT	
HVAC	
ELECTRICAL	
ELECTRIC LIGHT	
PLUMBING	
ADD. REQUIREMENTS	
TOTAL QTY: (1)	

*Indicates items will not be part of the project Base pricing, listed for planning and design purposes ONLY.

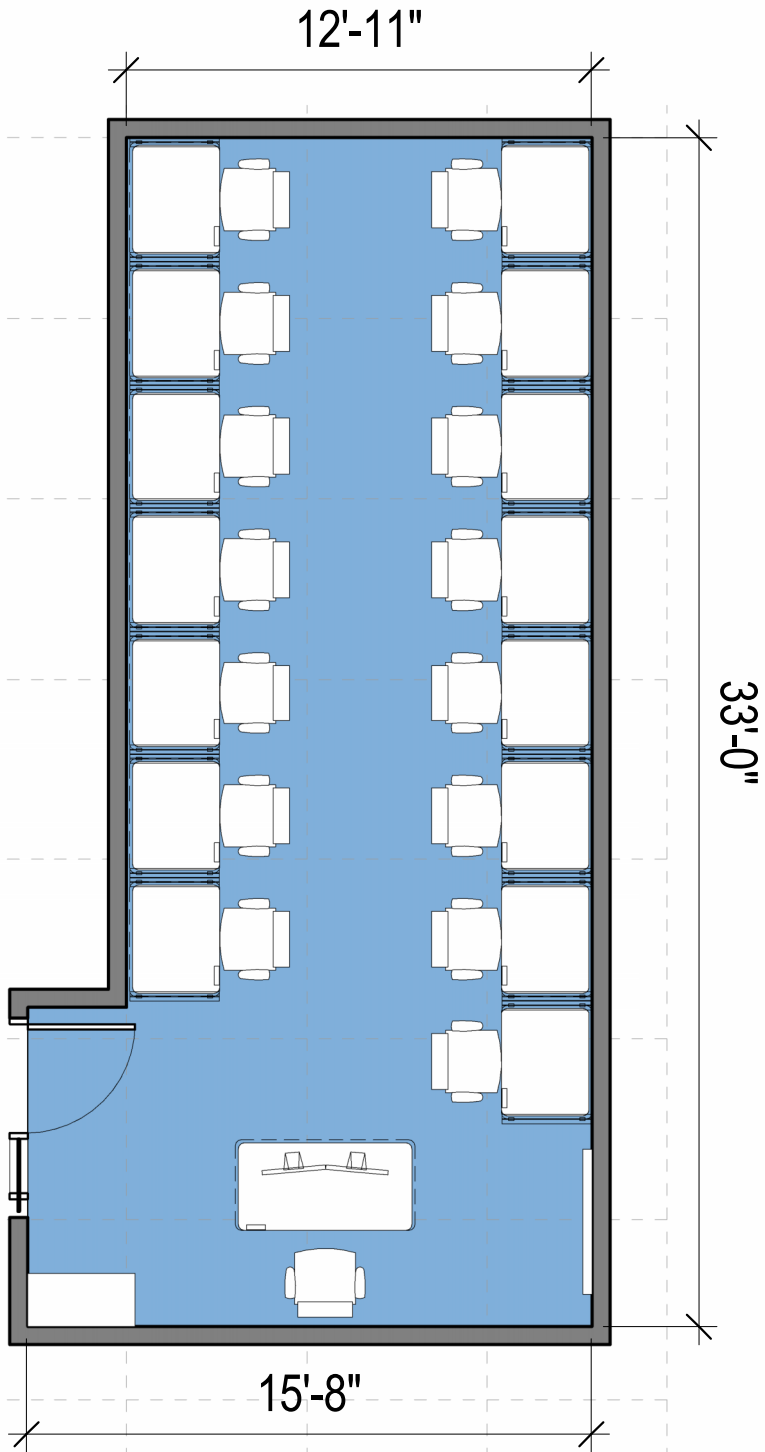

1 TESTING
SCALE: 3/16" = 1'-0"

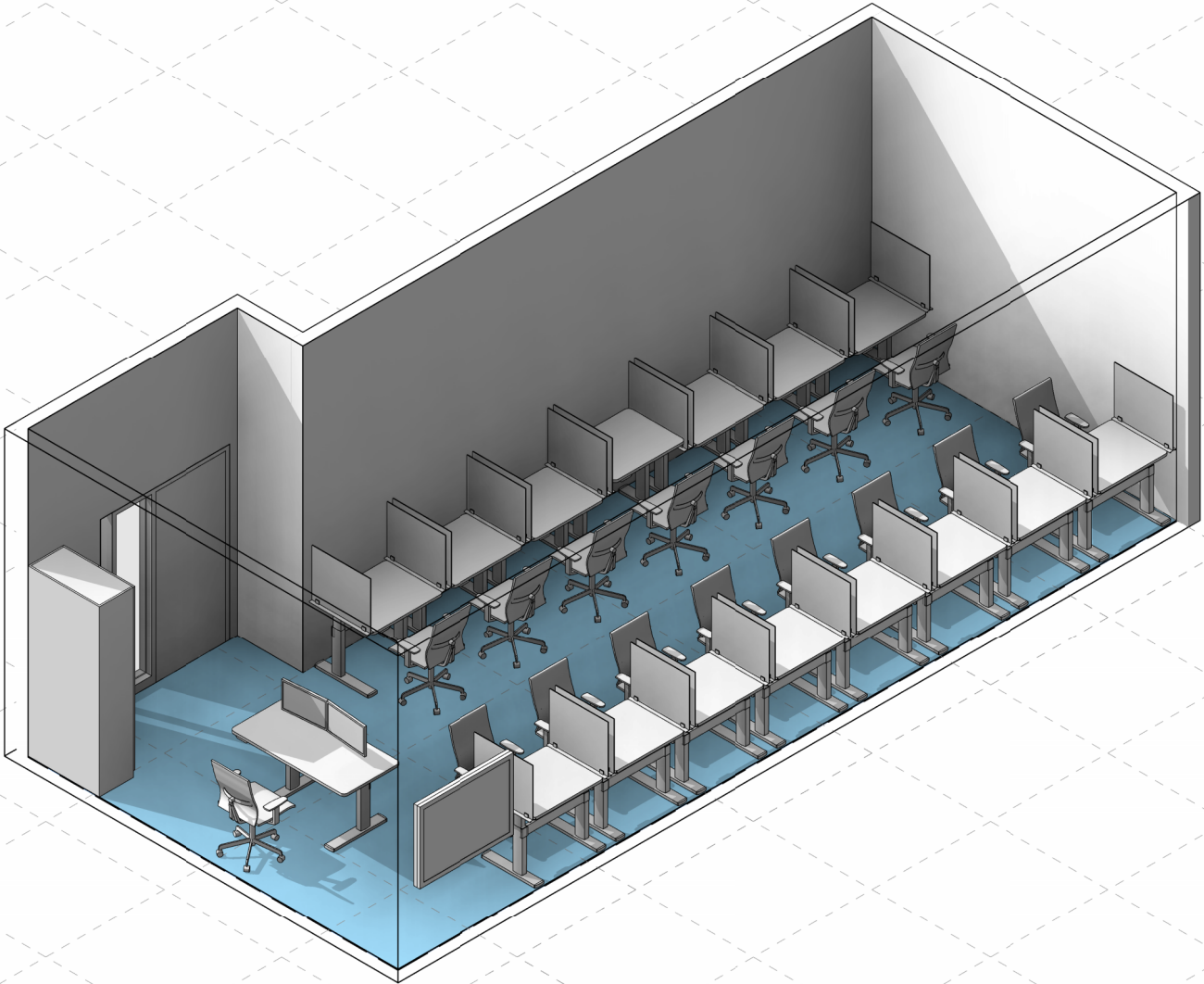

2 3D - TESTING
SCALE:

CODE	CNF-01 (400A)
DESCRIPTION	LAB EXERCISE SPACE / TESTING
DEPARTMENT	INSTRUCTIONAL LAB
SPACE TYPE	INSTRUCTIONAL LAB - APPLIED HEALTH
GENERAL	
PROGRAM AREA (NSF)	300 SF
ACTUAL AREA (NSF)	255 SF
PROGRAMED SEAT COUNT	5
FLOOR LOADING	
ACCESS	
ACOUSTICS	
SIGNAGE / WAYFINDING	
ELECTRONIC SECURITY	
SAFETY CONCERNS	
FINISHES (SEE PLANS)	
FLOORING	RESILIENT FLOORING (RF)
WALLS	PAINT (PT), WALL PROTECTION - RIGID SHEET (WP)
CEILING	ACOUSTIC TILE CEILING (CLG - ACT) & GYPSUM CEILING (CLG-GYP)
TECHNOLOGY REQMT	
EQUIPMENT, NETWORK, COMMUNICATIONS	
UTILITIES REQMT	
HVAC	
ELECTRICAL	
ELECTRIC LIGHT	
PLUMBING	
ADD. REQUIREMENTS	
TOTAL QTY: (1)	

*Indicates items will not be part of the project Base pricing, listed for planning and design purposes ONLY.

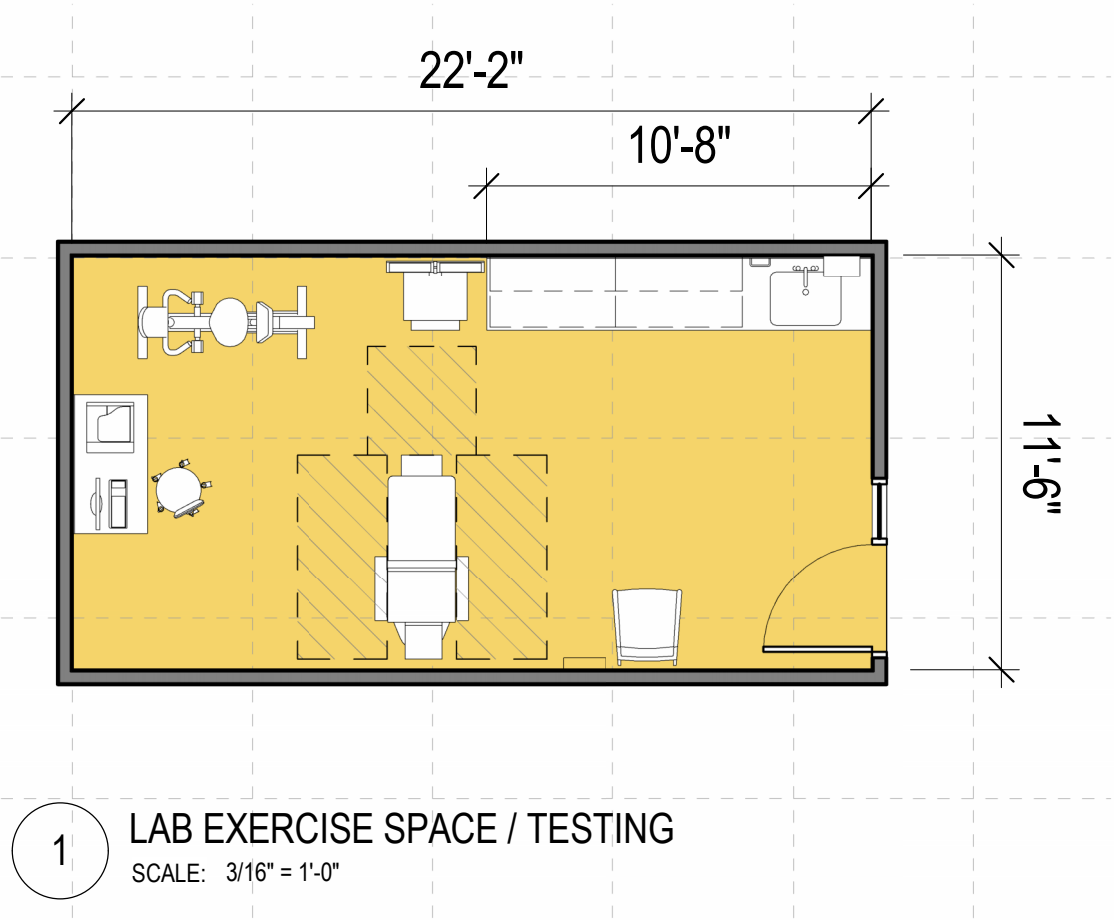

1 LAB EXERCISE SPACE / TESTING
SCALE: 3/16" = 1'-0"

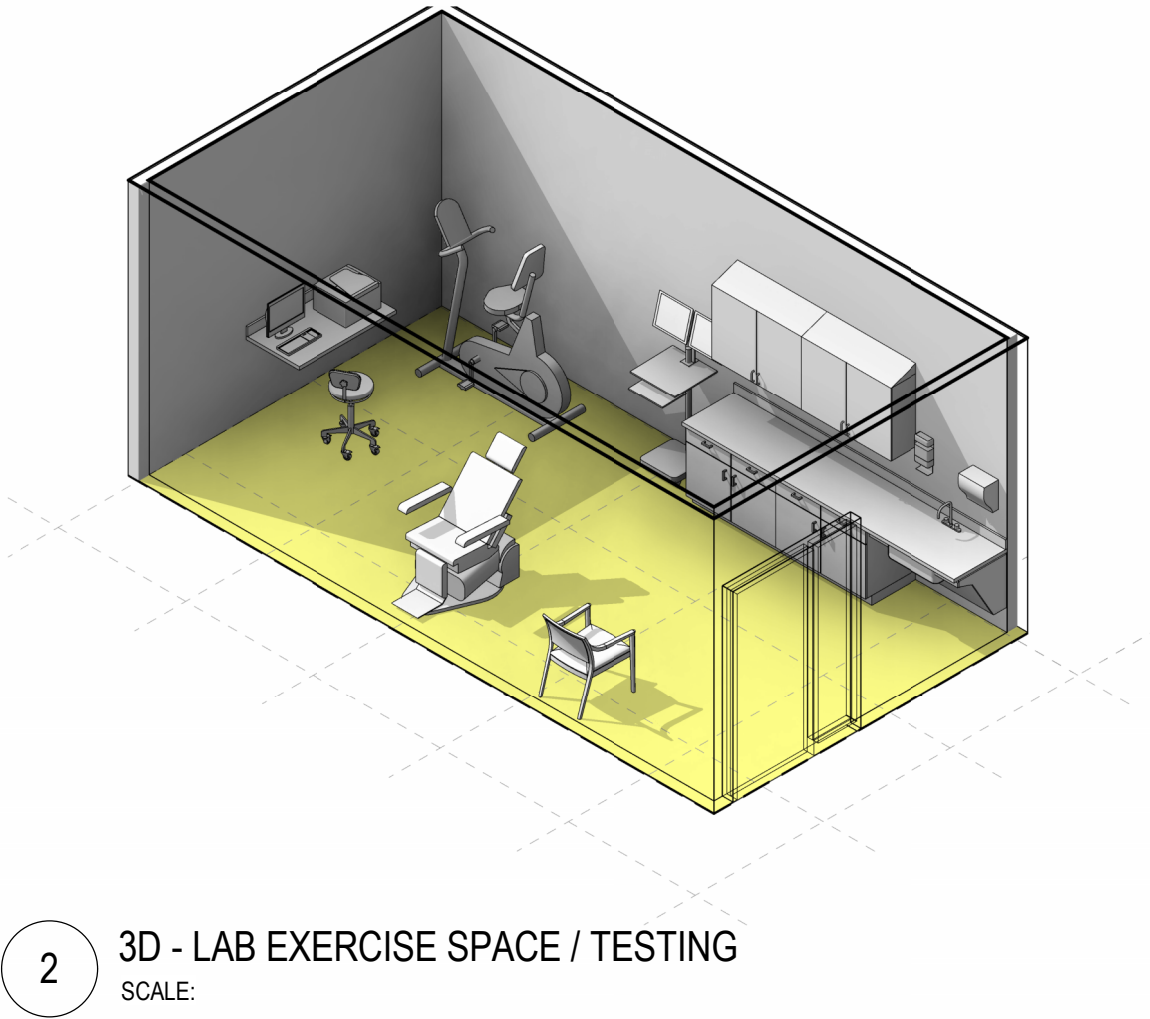

2 3D - LAB EXERCISE SPACE / TESTING
SCALE:

CODE	LAB.FALL-01
DESCRIPTION	LAB (FALL PREVENTION)
DEPARTMENT	INSTRUCTIONAL LAB
SPACE TYPE	INSTRUCTIONAL LAB - APPLIED HEALTH
GENERAL	
PROGRAM AREA (NSF)	1000 SF
ACTUAL AREA (NSF)	934 SF
PROGRAMED SEAT COUNT	15
FLOOR LOADING	
ACCESS	
ACOUSTICS	
SIGNAGE / WAYFINDING	
ELECTRONIC SECURITY	
SAFETY CONCERNS	
FINISHES (SEE PLANS)	
FLOORING	RESILIENT FLOORING (RF)
WALLS	PAINT (PT), ACOUSTIC FABRIC WRAPPED PANEL (FWP)
CEILING	ACOUSTIC TILE CEILING (CLG - ACT) & GYPSUM CEILING (CLG-GYP)
TECHNOLOGY REQMT	
EQUIPMENT, NETWORK, COMMUNICATIONS	
UTILITIES REQMT	
HVAC	
ELECTRICAL	
ELECTRIC LIGHT	PENDANT MOUNTED BAFFLED LINEAR DIRECT/INDIRECT AREA LIGHTING,RECESSED LINEAR WALL WASH
PLUMBING	
ADD. REQUIREMENTS	
TOTAL QTY: (1)	

*Indicates items will not be part of the project Base pricing, listed for planning and design purposes ONLY.

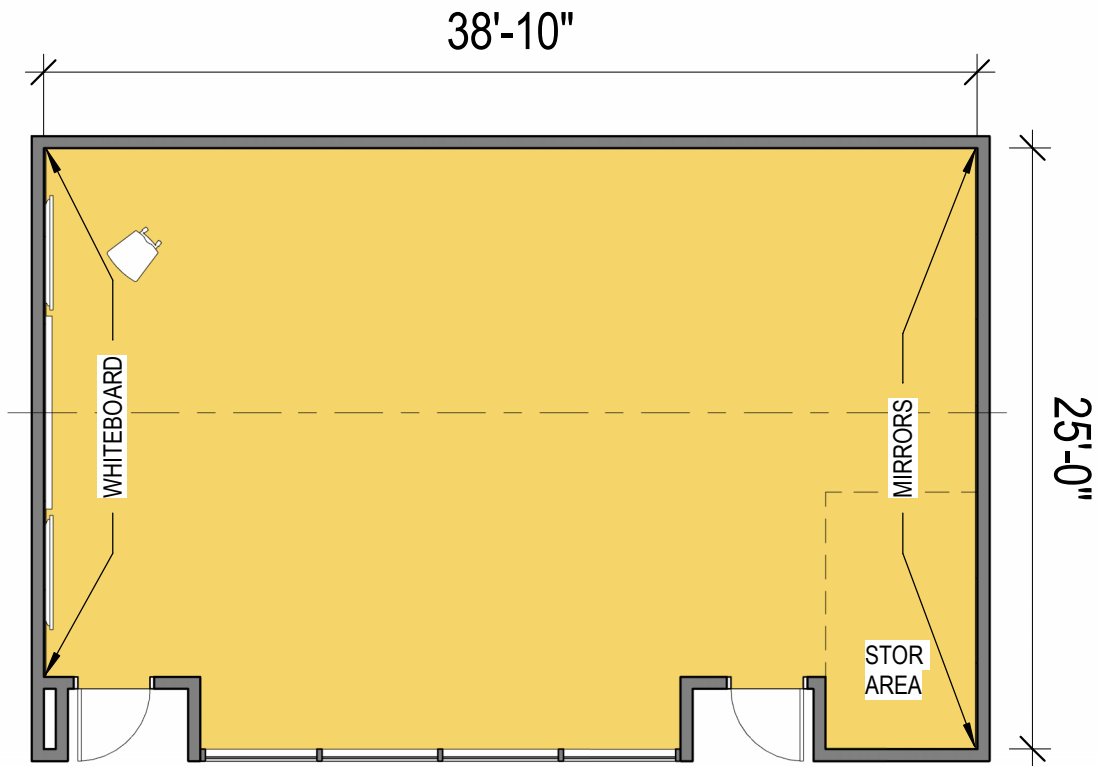

1 LAB (FALL PREVENTION) PLAN
SCALE: 1/8" = 1'-0"

FFE Schedule - LAB (FALL PREVENTION)			Furniture Schedule - LAB (FALL PREVENTION)
FURNITURE FURNISHING AND EQUIPMENT TYPE	DESCRIPTION	COUNT	Furniture Seat Count

USER NOTE: OPEN STUDIO SPACE

STACKABLE CHAIRS, SMALL WEIGHTS, EXERCISE BALLS, STORAGE, WALL MOUNTED DISPLAYS, MIRRORS ALONG ONE WALL AND WHITE OBARD ON ANOTHER

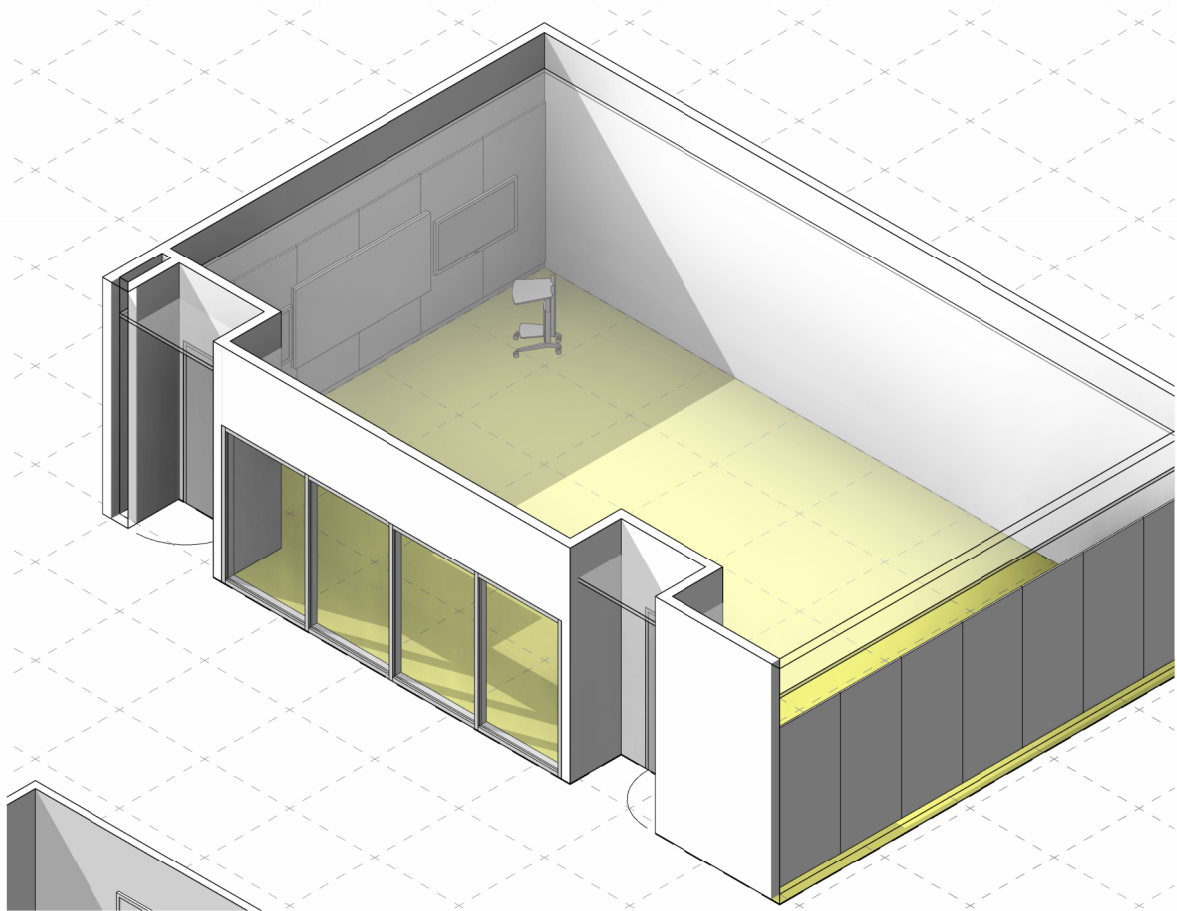

3 3D - LAB (FALL PREVENTION)
SCALE:

CODE	LAB.SIM-01
DESCRIPTION	LAB SPACE & AMBULANCE SIM GARAGE (EMT)
DEPARTMENT	INSTRUCTIONAL LAB
SPACE TYPE	INSTRUCTIONAL LAB - EMT
GENERAL	
PROGRAM AREA (NSF)	600 SF
ACTUAL AREA (NSF)	757 SF
PROGRAMED SEAT COUNT	10
FLOOR LOADING	
ACCESS	
ACOUSTICS	
SIGNAGE / WAYFINDING	
ELECTRONIC SECURITY	
SAFETY CONCERNS	
FINISHES (SEE PLANS)	
FLOORING	EXPOSED CONCRETE (CONC)
WALLS	PAINT (PT)
CEILING	EXPOSED (EX)
TECHNOLOGY REQMT	
EQUIPMENT, NETWORK, COMMUNICATIONS	
UTILITIES REQMT	
HVAC	
ELECTRICAL	
ELECTRIC LIGHT	RECESSED DOWN LIGHT AREA LIGHTING, RECESSED PERIMETER WALL WASH
PLUMBING	
ADD. REQUIREMENTS	
TOTAL QTY: (1)	

*Indicates items will not be part of the project Base pricing, listed for planning and design purposes ONLY.

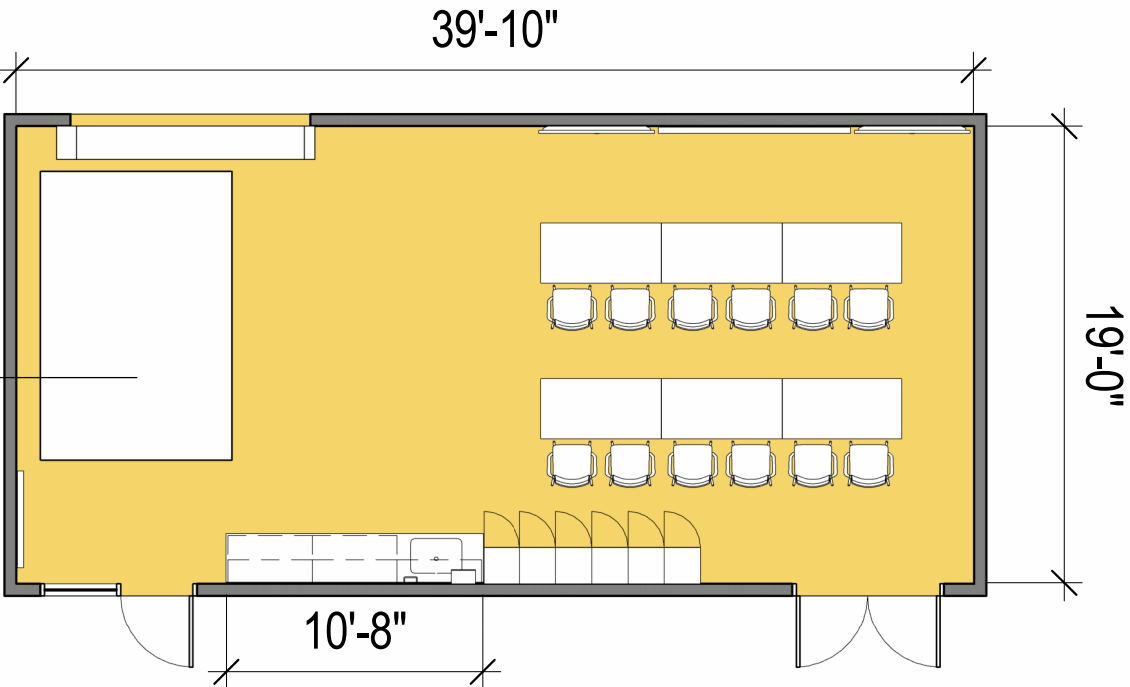

1 LAB SPACE & AMB SIM (EMT) PLAN
SCALE: 1/8" = 1'-0"

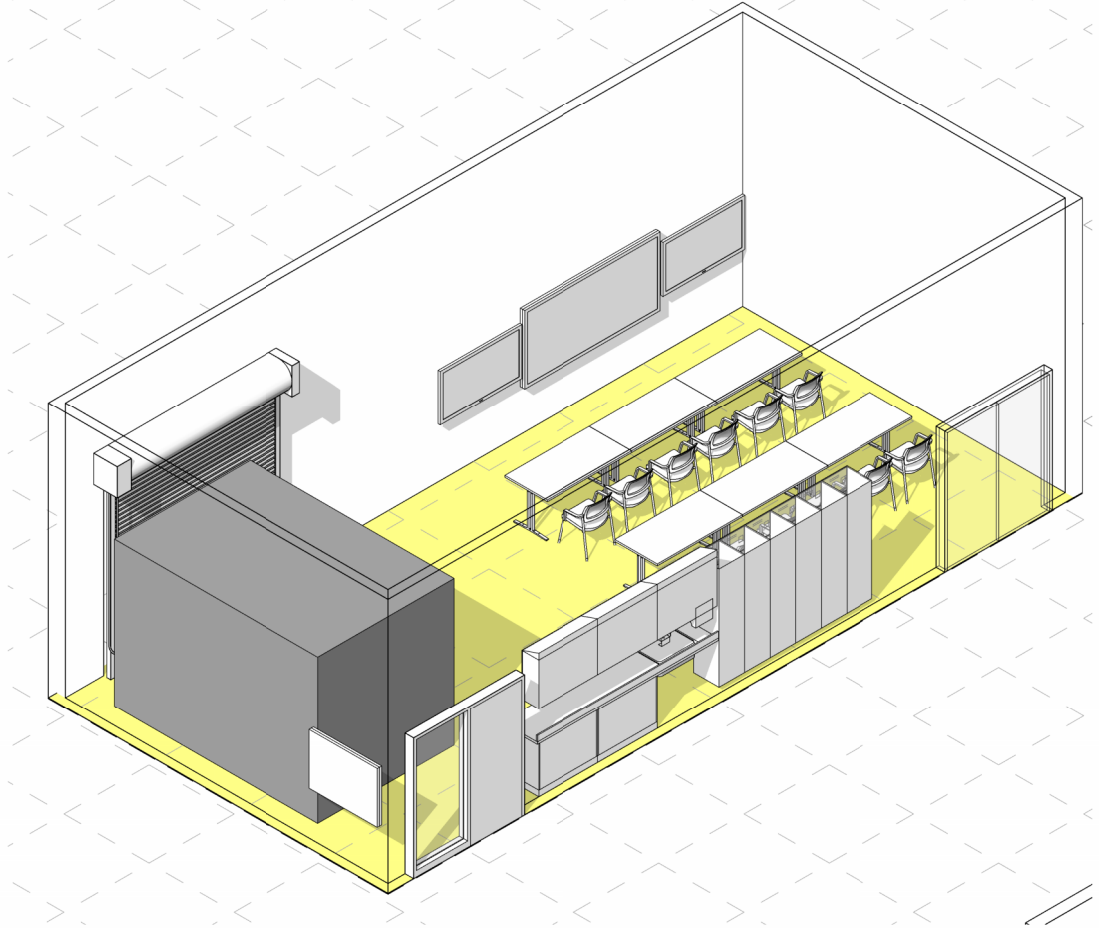

3 3D - LAB SPACE & AMB SIM (EMT)
SCALE:

FFE Schedule - LAB SPACE & AMBULANCE SIM GARAGE (EMT)		
FURNITURE FURNISHING AND EQUIPMENT TYPE	DESCRIPTION	COUNT

CODE	SP CNTRL
DESCRIPTION	STANDARDIZED PATIENT CONTROL ROOM
DEPARTMENT	
SPACE TYPE	
GENERAL	
PROGRAM AREA (NSF)	130 SF
ACTUAL AREA (NSF)	135 SF
PROGRAMED SEAT COUNT	
FLOOR LOADING	
ACCESS	
ACOUSTICS	
SIGNAGE / WAYFINDING	
ELECTRONIC SECURITY	
SAFETY CONCERNS	
FINISHES (SEE PLANS)	
FLOORING	RESILIENT FLOORING (RF)
WALLS	PAINT (PT)
CEILING	ACOUSTIC TILE CEILING (CLG - ACT)
TECHNOLOGY REQMT	
EQUIPMENT, NETWORK, COMMUNICATIONS	
UTILITIES REQMT	
HVAC	
ELECTRICAL	
ELECTRIC LIGHT	
PLUMBING	
ADD. REQUIREMENTS	

*Indicates items will not be part of the project Base pricing, listed for planning and design purposes ONLY.

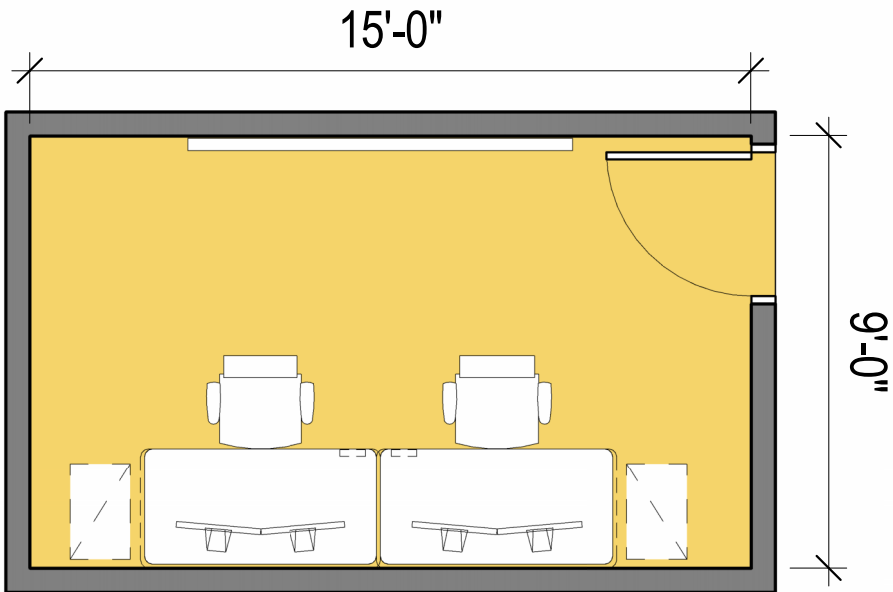

1 STANDARDIZED PATIENT CONTROL ROOM
SCALE: 1/4" = 1'-0"

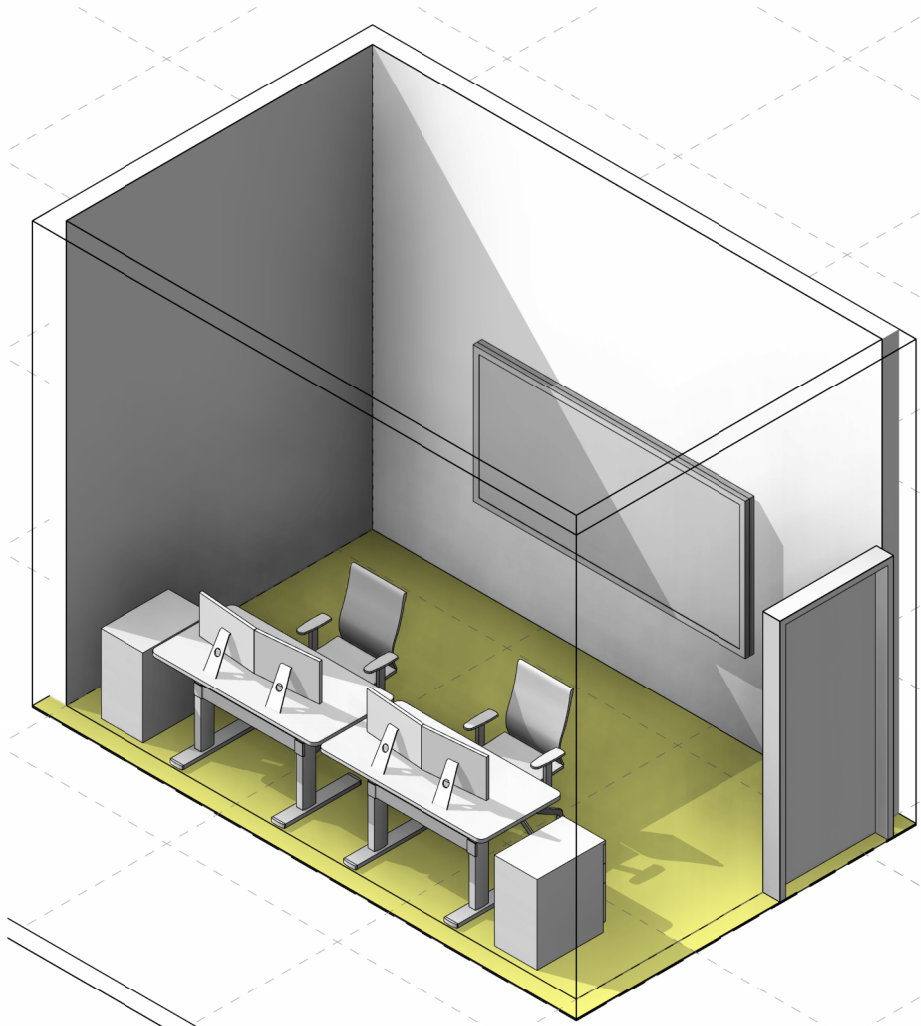

2 3D - STANDARDIZED PATIENT CONTROL ROOM
SCALE:

FFE Schedule - WORKROOM - TYPICAL (120 SQFT)		
FURNITURE FURNISHING AND EQUIPMENT TYPE	DESCRIPTION	COUNT

Furniture Schedule - ...
Furniture Seat Count

CODE	CTRL-01
DESCRIPTION	STANDARD CONTROL ROOM
DEPARTMENT	
SPACE TYPE	
GENERAL	
PROGRAM AREA (NSF)	200 SF
ACTUAL AREA (NSF)	150 SF
PROGRAMED SEAT COUNT	
FLOOR LOADING	
ACCESS	
ACOUSTICS	
SIGNAGE / WAYFINDING	
ELECTRONIC SECURITY	
SAFETY CONCERNS	
FINISHES (SEE PLANS)	
FLOORING	RESILIENT FLOORING (RF)
WALLS	PAINT (PT)
CEILING	ACOUSTIC TILE CEILING (CLG - ACT)
TECHNOLOGY REQMT	
EQUIPMENT, NETWORK, COMMUNICATIONS	
UTILITIES REQMT	
HVAC	
ELECTRICAL	
ELECTRIC LIGHT	
PLUMBING	
ADD. REQUIREMENTS	
TOTAL QTY: (1)	

*Indicates items will not be part of the project Base pricing, listed for planning and design purposes ONLY.

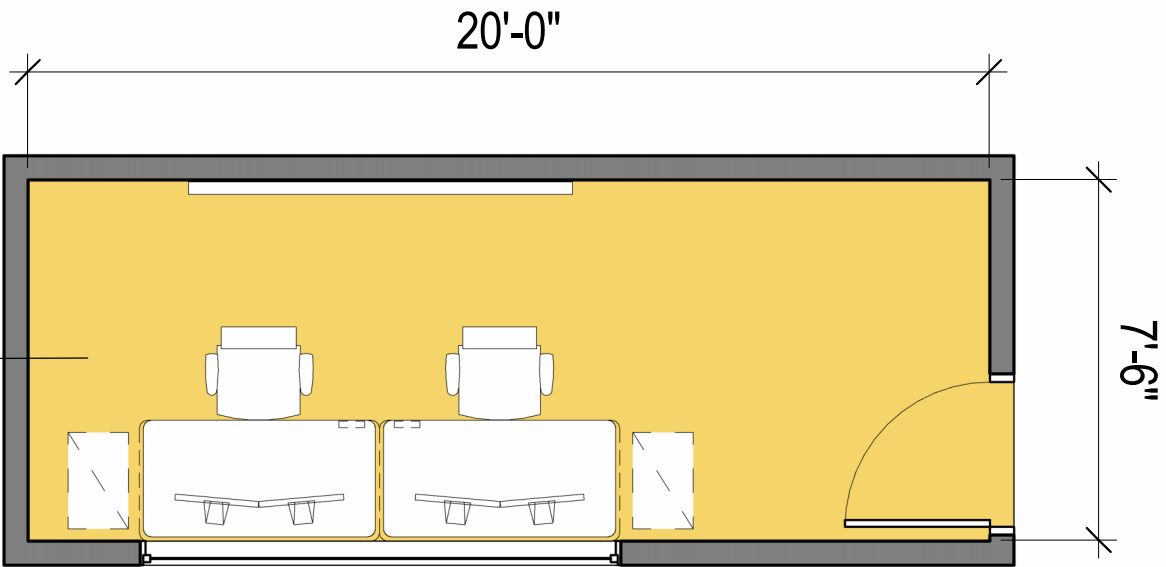

1 STANDARD CONTROL ROOM
SCALE: 1/4" = 1'-0"

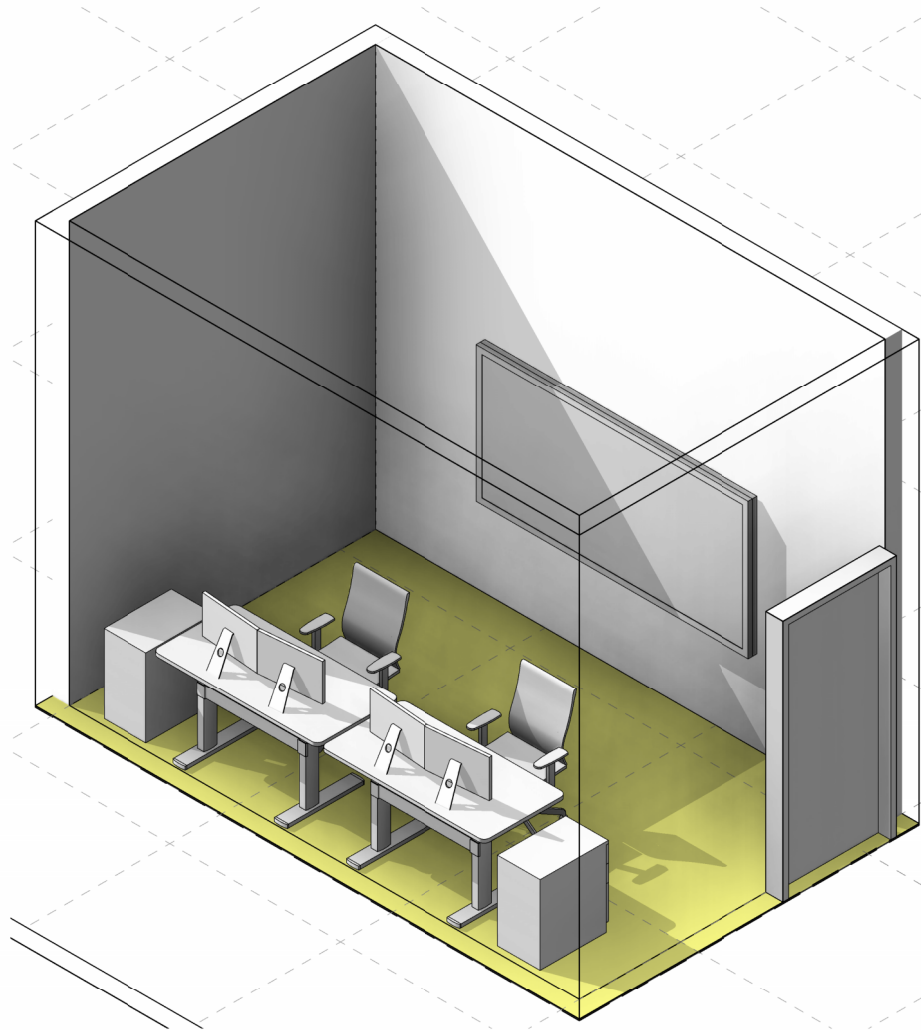

2 3D - STANDARD CONTROL ROOM
SCALE:

FFE Schedule - WORKROOM - TYPICAL (120 SQFT)

FURNITURE FURNISHING AND EQUIPMENT TYPE	DESCRIPTION	COUNT
---	-------------	-------

Furniture Schedule - ...

Furniture Seat Count

CODE	CTRL-02
DESCRIPTION	CONTROL ROOM, LARGE
DEPARTMENT	
SPACE TYPE	
GENERAL	
PROGRAM AREA (NSF)	400 SF
ACTUAL AREA (NSF)	240 SF
PROGRAMED SEAT COUNT	1
FLOOR LOADING	
ACCESS	
ACOUSTICS	
SIGNAGE / WAYFINDING	
ELECTRONIC SECURITY	
SAFETY CONCERNS	
FINISHES (SEE PLANS)	
FLOORING	CARPET (CPT)
WALLS	PAINT (PT)
CEILING	ACOUSTIC TILE CEILING (CLG - ACT)
TECHNOLOGY REQMT	
EQUIPMENT, NETWORK, COMMUNICATIONS	
UTILITIES REQMT	
HVAC	
ELECTRICAL	
ELECTRIC LIGHT	RECESSED LENSED 2X2 ARCHITECTURAL TROFFER
PLUMBING	
ADD. REQUIREMENTS	
TOTAL QTY: (1)	

*Indicates items will not be part of the project Base pricing, listed for planning and design purposes ONLY.

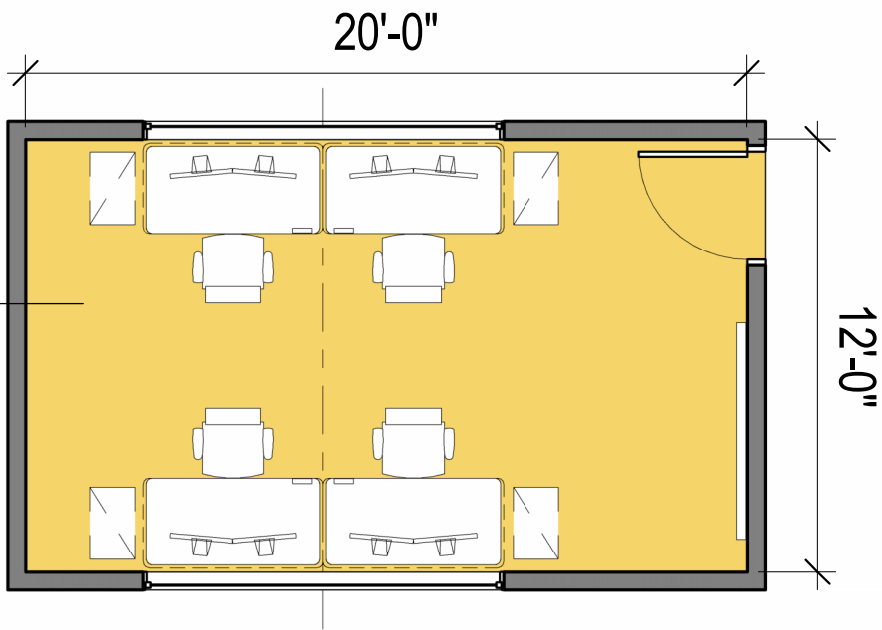

1 CONTROL ROOM, LARGE
SCALE: 3/16" = 1'-0"

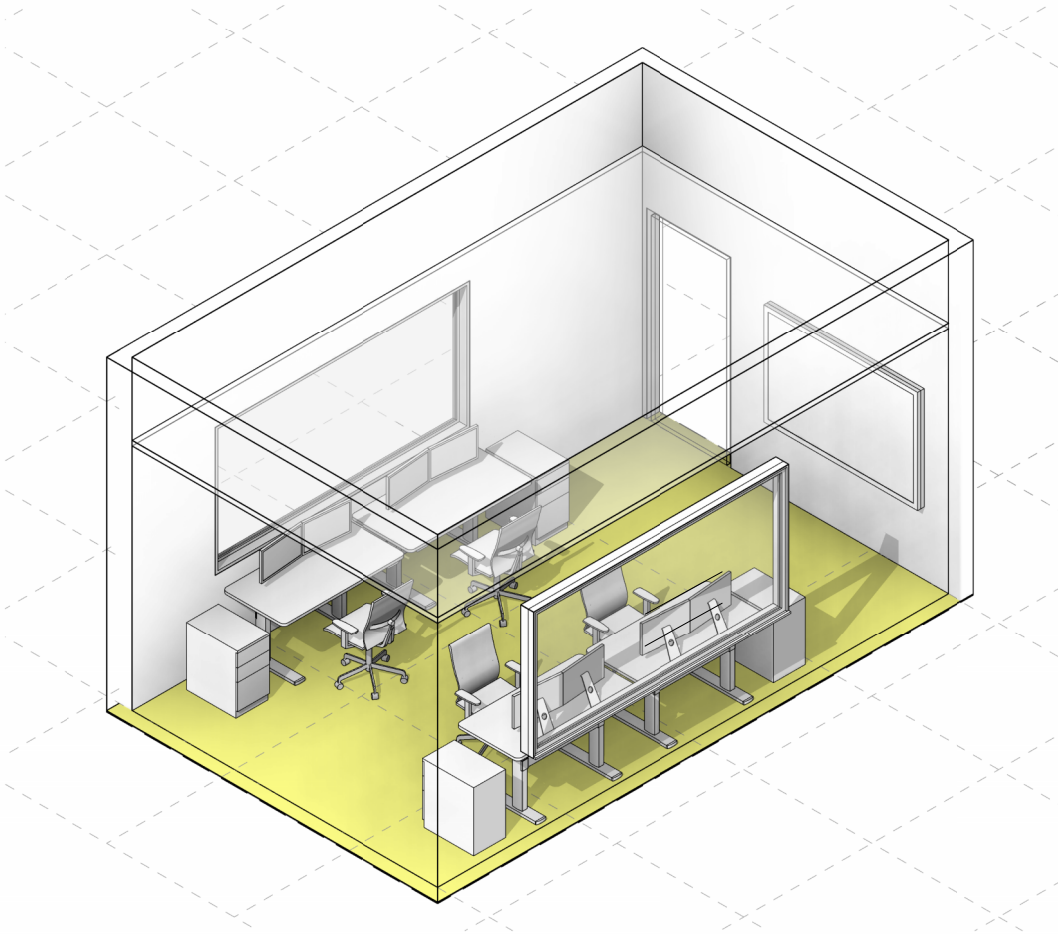

3 3D - CONTROL ROOM, LARGE
SCALE:

FFE Schedule - OFFICE, HOTELLING			Furniture Schedule - OFFICE, HOTELLING
FURNITURE FURNISHING AND EQUIPMENT TYPE	DESCRIPTION	COUNT	Furniture Seat Count

CODE	EXM-01, EXM-02, EXM-03
DESCRIPTION	EXAM ROOM
DEPARTMENT	INSTRUCTIONAL LABS
SPACE TYPE	CLINICAL EXAM (OUTPATIENT)
GENERAL	
PROGRAM AREA (NSF)	110 SF
ACTUAL AREA, (NSF)	149 SF
PROGRAMED SEAT COUNT	2
FLOOR LOADING	
ACCESS	
ACOUSTICS	
SIGNAGE / WAYFINDING	
ELECTRONIC SECURITY	
SAFETY CONCERNS	
FINISHES (SEE PLANS)	
FLOORING	RESILIENT FLOORING (RF)
WALLS	PAINT (PT), WALL PROTECTION - RIGID SHEET (WP)
CEILING	ACOUSTIC TILE CEILING (CLG - ACT)
TECHNOLOGY REQMT	
EQUIPMENT, NETWORK, COMMUNICATIONS	
UTILITIES REQMT	
HVAC	
ELECTRICAL	
ELECTRIC LIGHT	
PLUMBING	
ADD. REQUIREMENTS	
	TOTAL QTY: (3)

*Indicates items will not be part of the project Base pricing, listed for planning and design purposes ONLY.

1 EXAM ROOM/VR PLAN
SCALE: 3/16" = 1'-0"

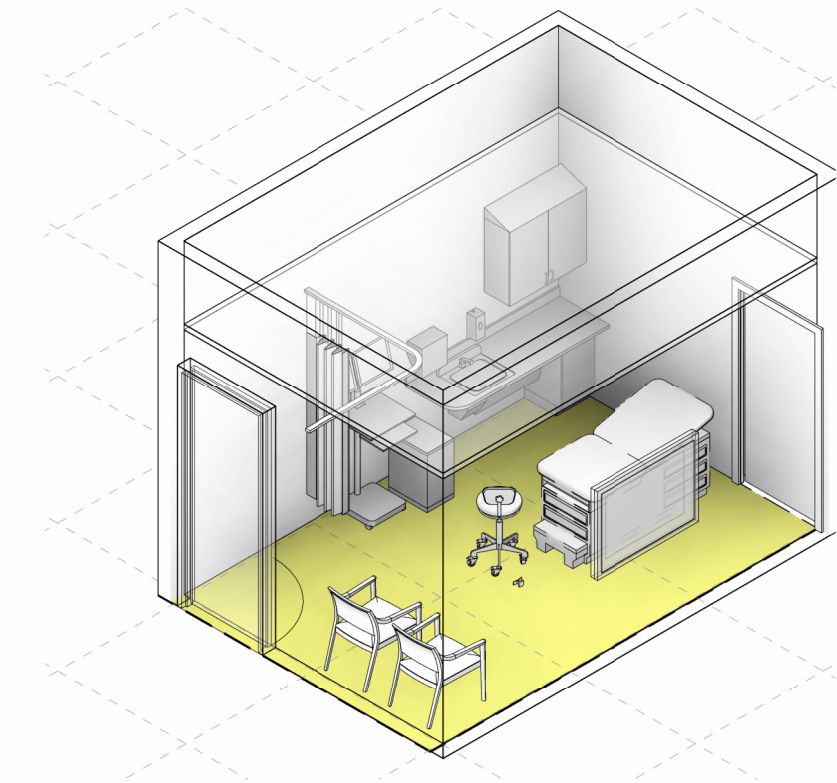
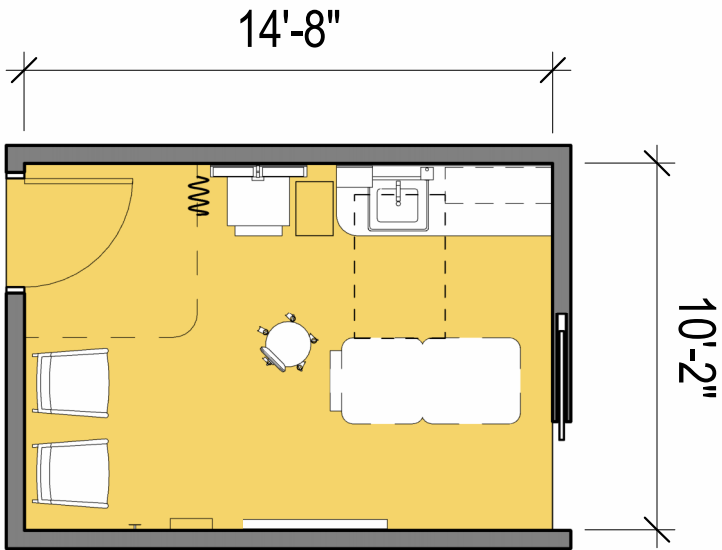

3 3D - EXAM ROOM/VR
SCALE:

FFE Schedule - EXAM ROOM / VR (PRIMARY CARE)

FURNITURE FURNISHING AND EQUIPMENT TYPE	DESCRIPTION	COUNT
---	-------------	-------

TACKBOARD ONLY

CODE	EXM-04
DESCRIPTION	EXAM ROOM (LARGE)
DEPARTMENT	INSTRUCTIONAL LABS
SPACE TYPE	CLINICAL EXAM (OUTPATIENT)
GENERAL	
PROGRAM AREA (NSF)	150 SF
ACTUAL AREA (NSF)	161 SF
PROGRAMED SEAT COUNT	1
FLOOR LOADING	
ACCESS	
ACOUSTICS	
SIGNAGE / WAYFINDING	
ELECTRONIC SECURITY	
SAFETY CONCERNS	
FINISHES (SEE PLANS)	
FLOORING	RESILIENT FLOORING (RF)
WALLS	PAINT (PT), WALL PROTECTION - RIGID SHEET (WP)
CEILING	ACOUSTIC TILE CEILING (CLG - ACT)
TECHNOLOGY REQMT	
EQUIPMENT, NETWORK, COMMUNICATIONS	
UTILITIES REQMT	
HVAC	
ELECTRICAL	
ELECTRIC LIGHT	RECESSED LENSED LINEAR
PLUMBING	
ADD. REQUIREMENTS	

*Indicates items will not be part of the project Base pricing, listed for planning and design purposes ONLY.

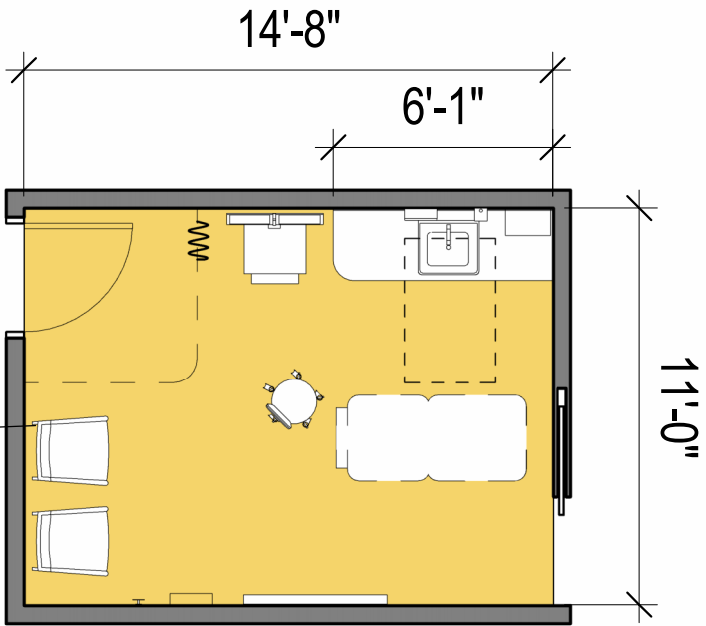

1 EXAM ROOM (LARGE) PLAN
SCALE: 3/16" = 1'-0"

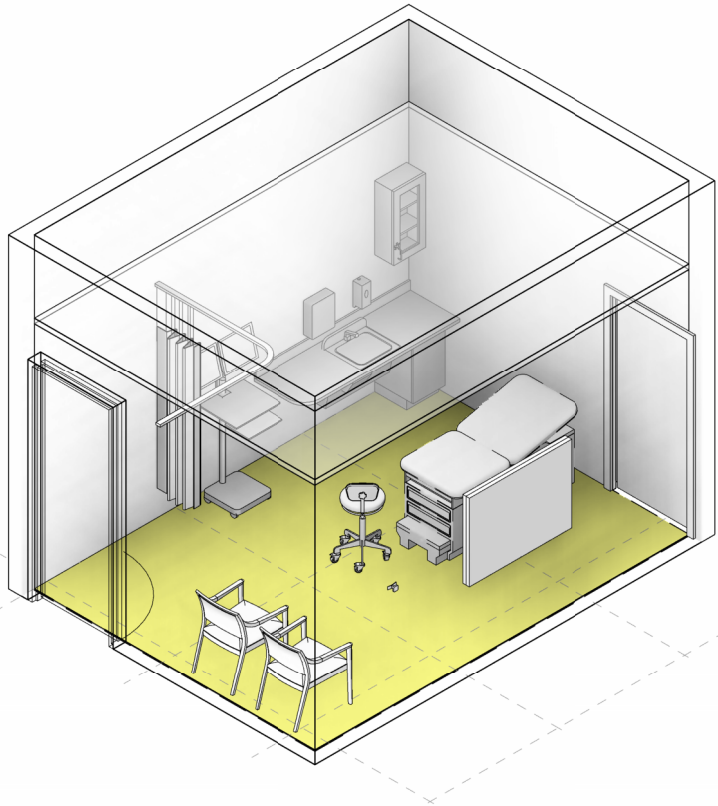

3 3D - EXAM ROOM (LARGE)
SCALE:

FFE Schedule - EXAM ROOM (LARGE)

FURNITURE FURNISHING AND EQUIPMENT TYPE	DESCRIPTION	COUNT
---	-------------	-------

CODE	BRF-01, BRF-02, BRF-03
DESCRIPTION	BRIEF / DEBRIEF ROOM
DEPARTMENT	INSTRUCTIONAL LABS
SPACE TYPE	CLINICAL EXAM (OUTPATIENT) / IMMERSIVE SIMULATION (INPATIENT)
GENERAL	
PROGRAM AREA (NSF)	250 SF
ACTUAL AREA. (NSF)	296 SF
PROGRAMED SEAT COUNT	10
FLOOR LOADING	
ACCESS	
ACOUSTICS	
SIGNAGE / WAYFINDING	
ELECTRONIC SECURITY	
SAFETY CONCERNS	
FINISHES (SEE PLANS)	
FLOORING	RESILIENT FLOORING (RF)
WALLS	PAINT (PT)
CEILING	ACOUSTIC TILE CEILING (CLG - ACT)
TECHNOLOGY REQMT	
EQUIPMENT, NETWORK, COMMUNICATIONS	
UTILITIES REQMT	
HVAC	
ELECTRICAL	
ELECTRIC LIGHT	RECESSED BAFFLED LINEAR AREA LIGHTING, RECESSED LINEAR WALL WASH
PLUMBING	
ADD. REQUIREMENTS	
	TOTAL QTY: (2)

*Indicates items will not be part of the project Base pricing, listed for planning and design purposes ONLY.

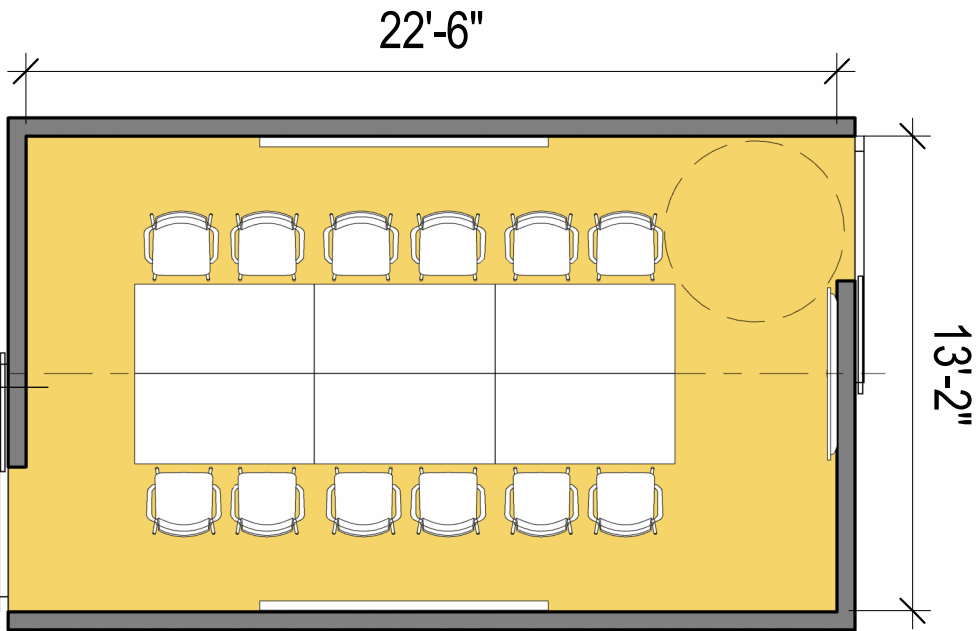

1 BRIEF/DEBRIEF ROOM PLAN
SCALE: 3/16" = 1'-0"

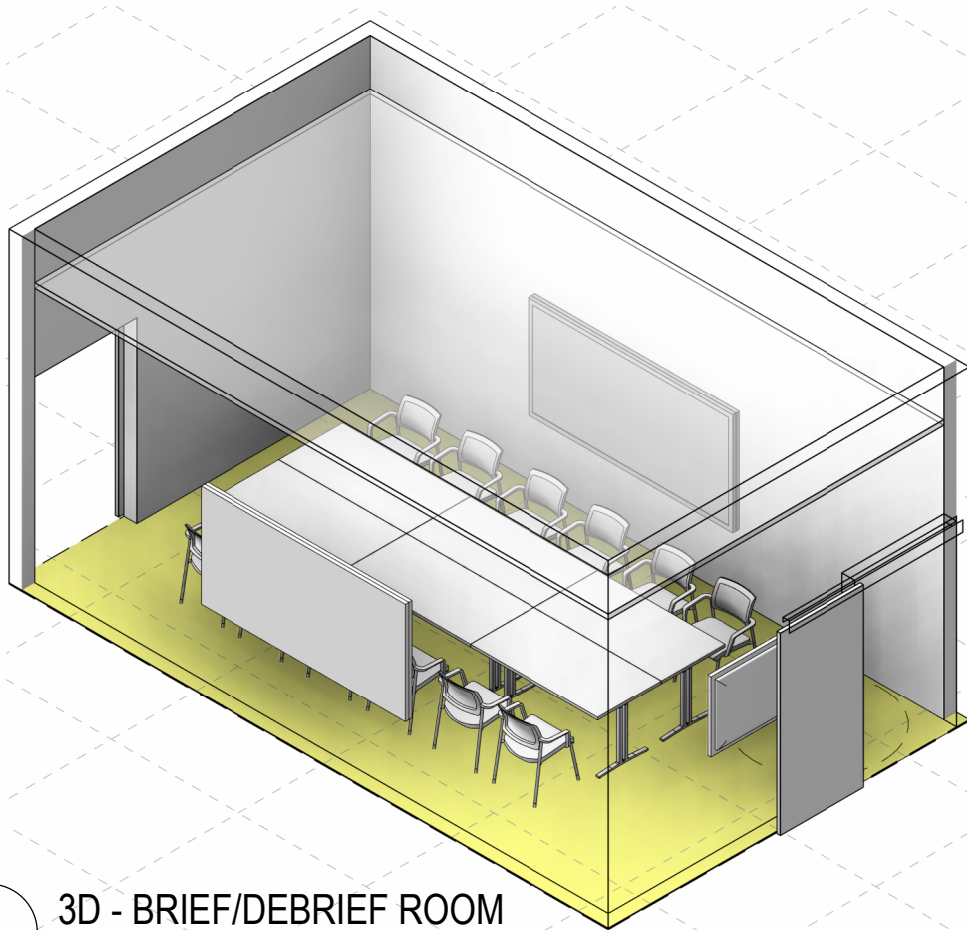

3 3D - BRIEF/DEBRIEF ROOM
SCALE:

FFE Schedule - BRIEF / DEBRIEF ROOM			Furniture Schedule - BRIEF / DEBRIEF ROOM
FURNITURE FURNISHING AND EQUIPMENT TYPE	DESCRIPTION	COUNT	Furniture Seat Count

CODE	SIM.LAB-01, SIM.LAB-02
DESCRIPTION	HIGH FIDELITY SIMULATION LAB
DEPARTMENT	INSTRUCTIONAL LAB
SPACE TYPE	IMMERSIVE SIMULATION (INPATIENT)
GENERAL	
PROGRAM AREA (NSF)	275 SF
ACTUAL AREA (NSF)	278 SF
PROGRAMED SEAT COUNT	4
FLOOR LOADING	
ACCESS	
ACOUSTICS	
SIGNAGE / WAYFINDING	
ELECTRONIC SECURITY	
SAFETY CONCERNS	
FINISHES (SEE PLANS)	
FLOORING	RESILIENT FLOORING (RF)
WALLS	PAINT (PT), WALL PROTECTION - RIGID SHEET (WP)
CEILING	ACOUSTIC TILE CEILING (CLG - ACT)
TECHNOLOGY REQMT	
EQUIPMENT, NETWORK, COMMUNICATIONS	
UTILITIES REQMT	
HVAC	
ELECTRICAL	
ELECTRIC LIGHT	RECESSED LENSED LINEAR
PLUMBING	
ADD. REQUIREMENTS	
TOTAL QTY: (2)	

*Indicates items will not be part of the project Base pricing, listed for planning and design purposes ONLY.

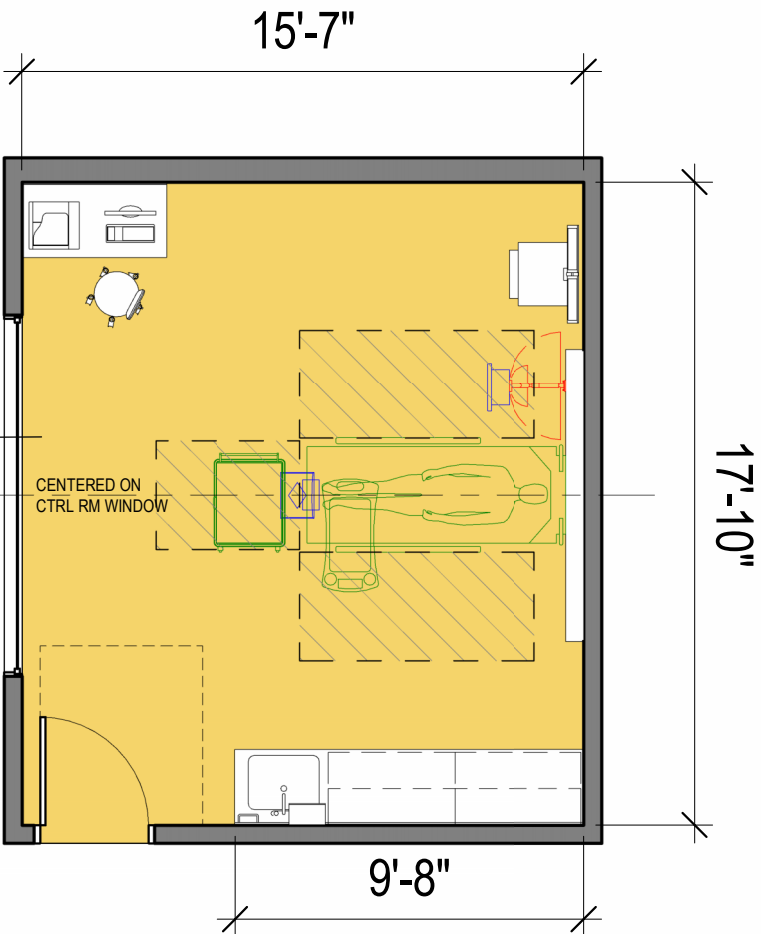

1 HIGH FIDELITY SIMULATION LAB PLAN
SCALE: 3/16" = 1'-0"

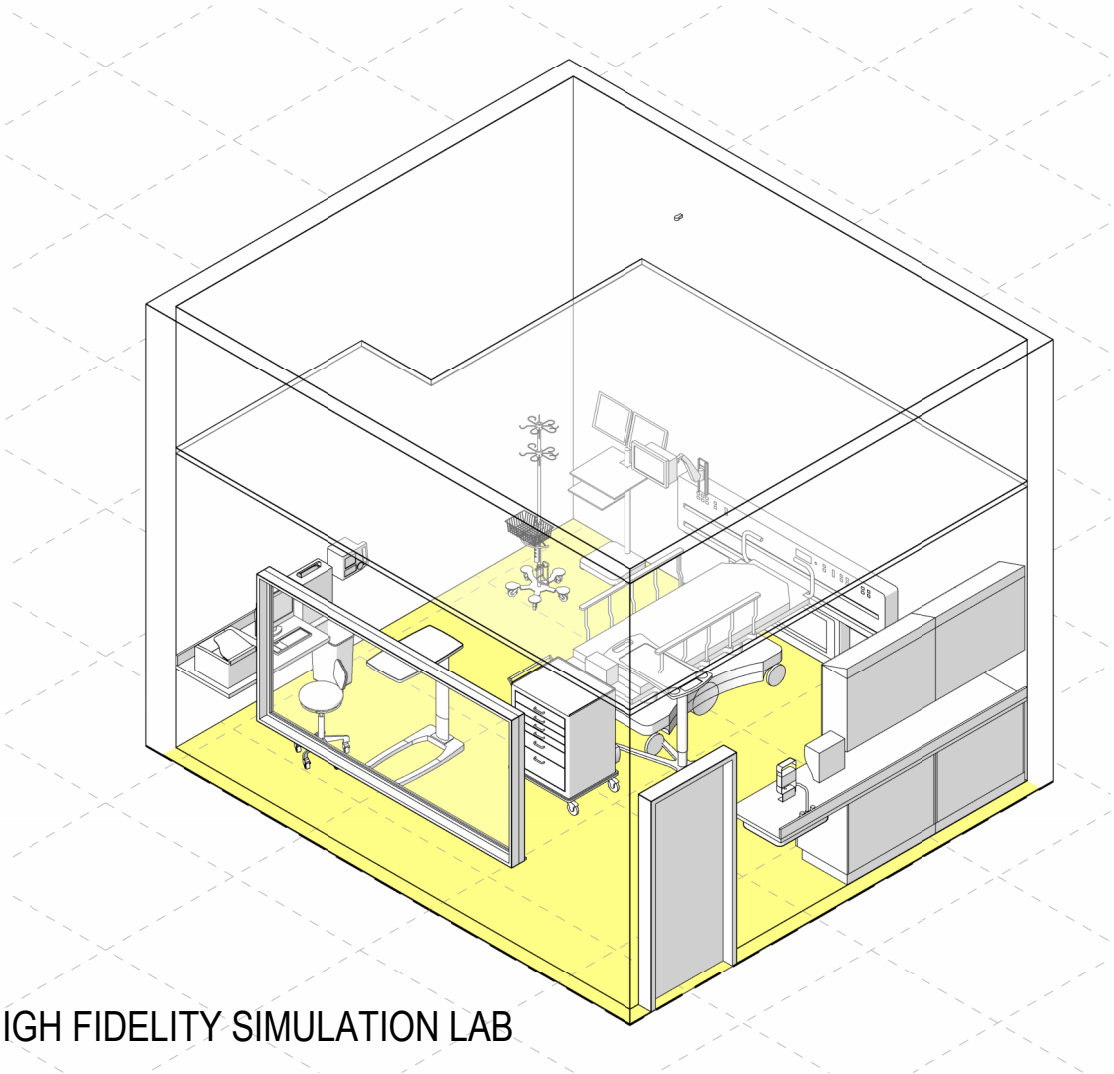

3 3D - HIGH FIDELITY SIMULATION LAB
SCALE:

FFE Schedule - HIGH FIDELITY SIMULATION LAB		
FURNITURE FURNISHING AND EQUIPMENT TYPE	DESCRIPTION	COUNT

CODE	SIM.LAB-03
DESCRIPTION	HIGH FIDELITY SIMULATION LAB (LRG)
DEPARTMENT	INSTRUCTIONAL LAB
SPACE TYPE	IMMERSIVE SIMULATION (INPATIENT)
GENERAL	
PROGRAM AREA (NSF)	400 SF
ACTUAL AREA. (NSF)	345 SF
PROGRAMED SEAT COUNT	4
FLOOR LOADING	
ACCESS	
ACOUSTICS	
SIGNAGE / WAYFINDING	
ELECTRONIC SECURITY	
SAFETY CONCERNS	
FINISHES (SEE PLANS)	
FLOORING	RESILIENT FLOORING (RF)
WALLS	PAINT (PT), WALL PROTECTION - RIGID SHEET (WP)
CEILING	ACOUSTIC TILE CEILING (CLG - ACT)
TECHNOLOGY REQMT	
EQUIPMENT, NETWORK, COMMUNICATIONS	
UTILITIES REQMT	
HVAC	
ELECTRICAL	
ELECTRIC LIGHT	RECESSED LENSED 2X2
PLUMBING	
ADD. REQUIREMENTS	
TOTAL QTY: (1)	

*Indicates items will not be part of the project Base pricing, listed for planning and design purposes ONLY.

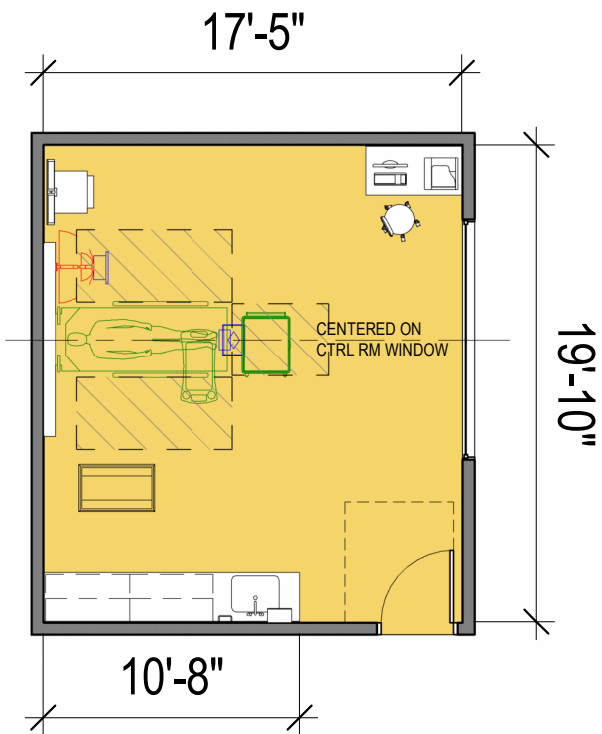

1 HIGH FIDELITY SIMULATION LAB (LRG) PLAN
SCALE: 1/8" = 1'-0"

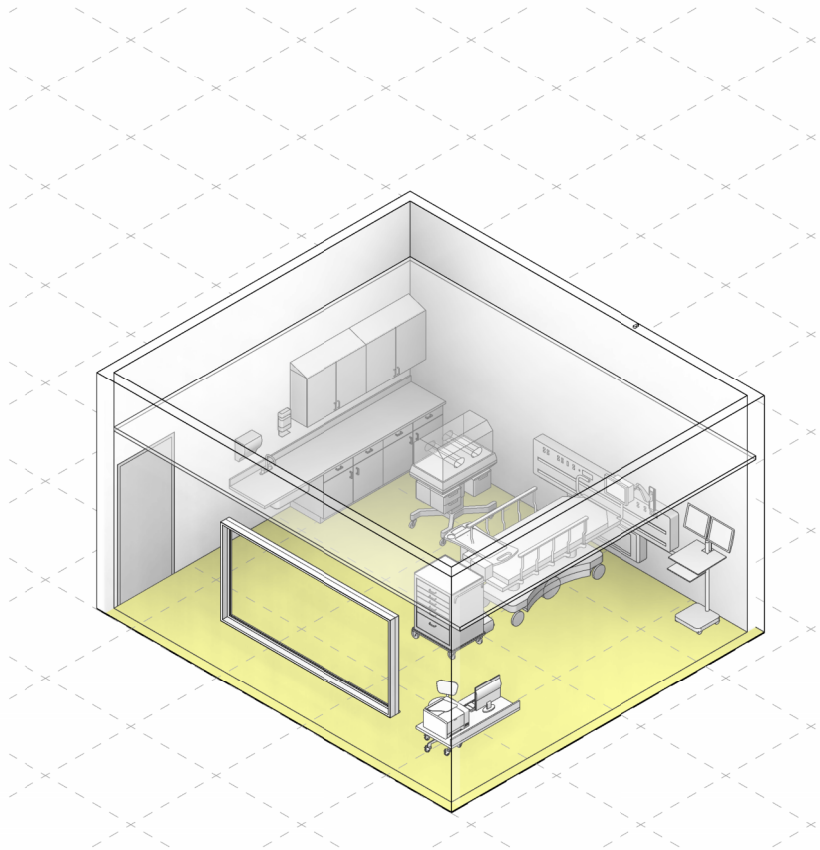

3 3D - HIGH FIDELITY SIMULATION LAB (LRG)
SCALE:

FFE Schedule - HIGH FIDELITY SIMULATION LAB (LARGE)		
FURNITURE FURNISHING AND EQUIPMENT TYPE	DESCRIPTION	COUNT

CODE	VR-01
DESCRIPTION	MIXED REALITY / VR / BLACK BOX
DEPARTMENT	INSTRUCTIONAL LAB
SPACE TYPE	IMMERSIVE SIMULATION (INPATIENT)
GENERAL	
PROGRAM AREA (NSF)	400 SF
ACTUAL AREA. (NSF)	418 SF
PROGRAMED SEAT COUNT	4
FLOOR LOADING	
ACCESS	
ACOUSTICS	
SIGNAGE / WAYFINDING	
ELECTRONIC SECURITY	
SAFETY CONCERNS	
FINISHES (SEE PLANS)	
FLOORING	RESILIENT FLOORING (RF)
WALLS	PAINT (PT)
CEILING	EXPOSED BLACK
TECHNOLOGY REQMT	
EQUIPMENT, NETWORK, COMMUNICATIONS	
UTILITIES REQMT	
HVAC	
ELECTRICAL	
ELECTRIC LIGHT	RECESSED LENSED 2X2
PLUMBING	
ADD. REQUIREMENTS	
	TOTAL QTY: (1)

*Indicates items will not be part of the project Base pricing, listed for planning and design purposes ONLY.

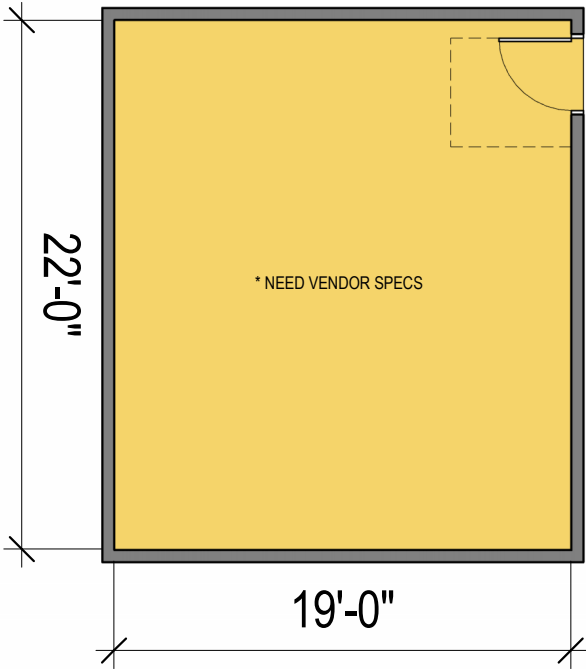

1 VR/BLACK BOX PLAN
SCALE: 1/8" = 1'-0"

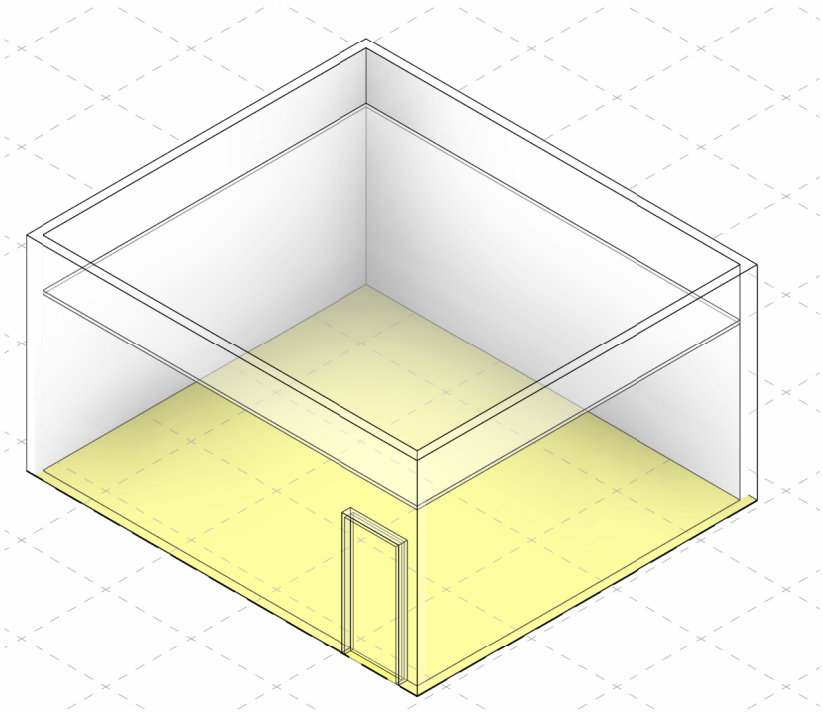

3 3D - VR/BLACK BOX
SCALE:

FFE Schedule - MIXED REALITY/VR/BLACK BOX		
FURNITURE FURNISHING AND EQUIPMENT TYPE	DESCRIPTION	COUNT

CODE	LIV.LAB-01
DESCRIPTION	ACTIVITIES OF DAILY LIVING LAB
DEPARTMENT	INSTRUCTIONAL LAB
SPACE TYPE	IMMERSIVE SIMULATION (INPATIENT)
GENERAL	
PROGRAM AREA (NSF)	600 SF
ACTUAL AREA (NSF)	499 SF
PROGRAMED SEAT COUNT	10
FLOOR LOADING	
ACCESS	
ACOUSTICS	
SIGNAGE / WAYFINDING	
ELECTRONIC SECURITY	
SAFETY CONCERNS	
FINISHES (SEE PLANS)	
FLOORING	RESILIENT FLOORING (RF)
WALLS	PAINT (PT), WALL PROTECTION - RIGID SHEET (WP)
CEILING	GYPSUM BOARD CEILING (CLG - GYB)
TECHNOLOGY REQMT	
EQUIPMENT, NETWORK, COMMUNICATIONS	
UTILITIES REQMT	
HVAC	
ELECTRICAL	
ELECTRIC LIGHT	RECESSED LENSED 2X2
PLUMBING	
ADD. REQUIREMENTS	
TOTAL QTY: (1)	

*Indicates items will not be part of the project Base pricing, listed for planning and design purposes ONLY.

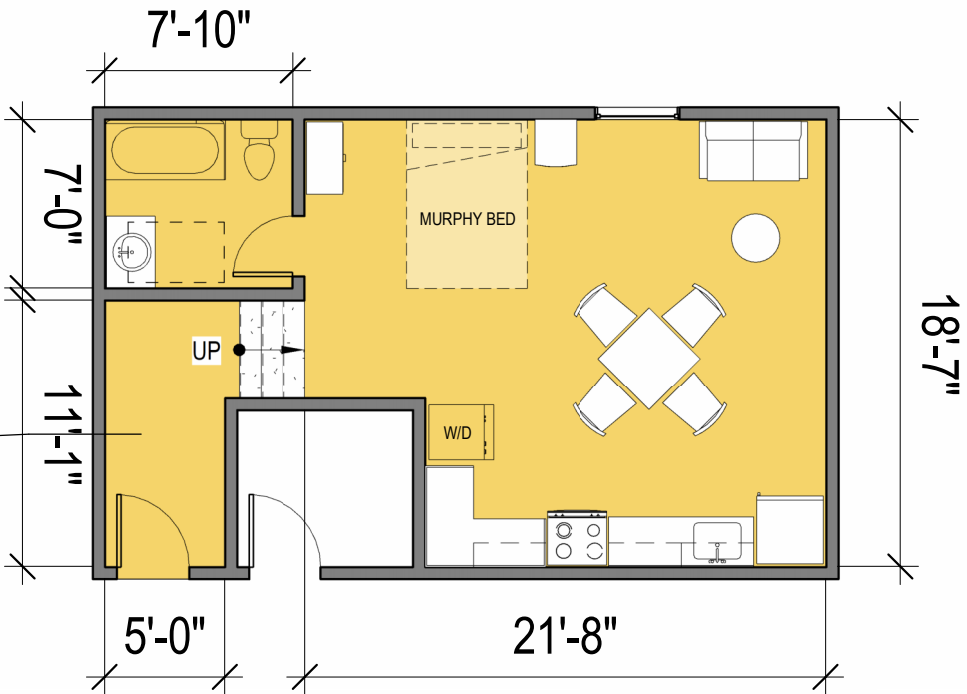

1 ACTIVITIES OF DAILY LIVING LAB PLAN
SCALE: 1/8" = 1'-0"

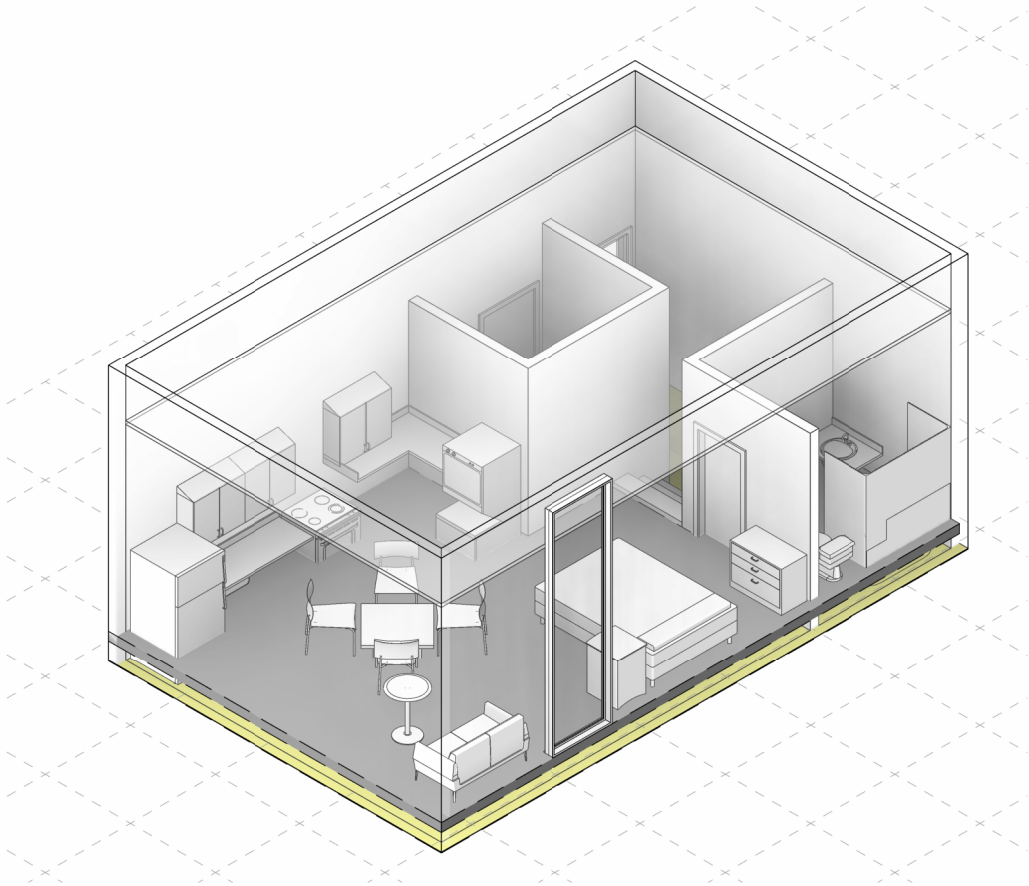

3 3D - ACTIVITIES OF DAILY LIVING LAB
SCALE:

FFE Schedule - ACTIVITIES OF DAILY LIVING LAB		
FURNITURE FURNISHING AND EQUIPMENT TYPE	DESCRIPTION	COUNT

CODE	MAKER
DESCRIPTION	MAKER / MOULAGE
DEPARTMENT	
SPACE TYPE	SUPPORT
GENERAL	
PROGRAM AREA (NSF)	320 SF
ACTUAL AREA (NSF)	312 SF
PROGRAMED SEAT COUNT	
FLOOR LOADING	
ACCESS	
ACOUSTICS	
SIGNAGE / WAYFINDING	
ELECTRONIC SECURITY	
SAFETY CONCERNS	
FINISHES (SEE PLANS)	
FLOORING	RESILIENT FLOORING (RF)
WALLS	PAINT (PT), WALL PROTECTION - RIGID SHEET (WP)
CEILING	ACOUSTIC TILE CEILING (CLG - ACT) & GYPSUM CEILING (CLG-GYP)
TECHNOLOGY REQMT	
EQUIPMENT, NETWORK, COMMUNICATIONS	
UTILITIES REQMT	
HVAC	
ELECTRICAL	
ELECTRIC LIGHT	
PLUMBING	
ADD. REQUIREMENTS	

*Indicates items will not be part of the project Base pricing, listed for planning and design purposes ONLY.

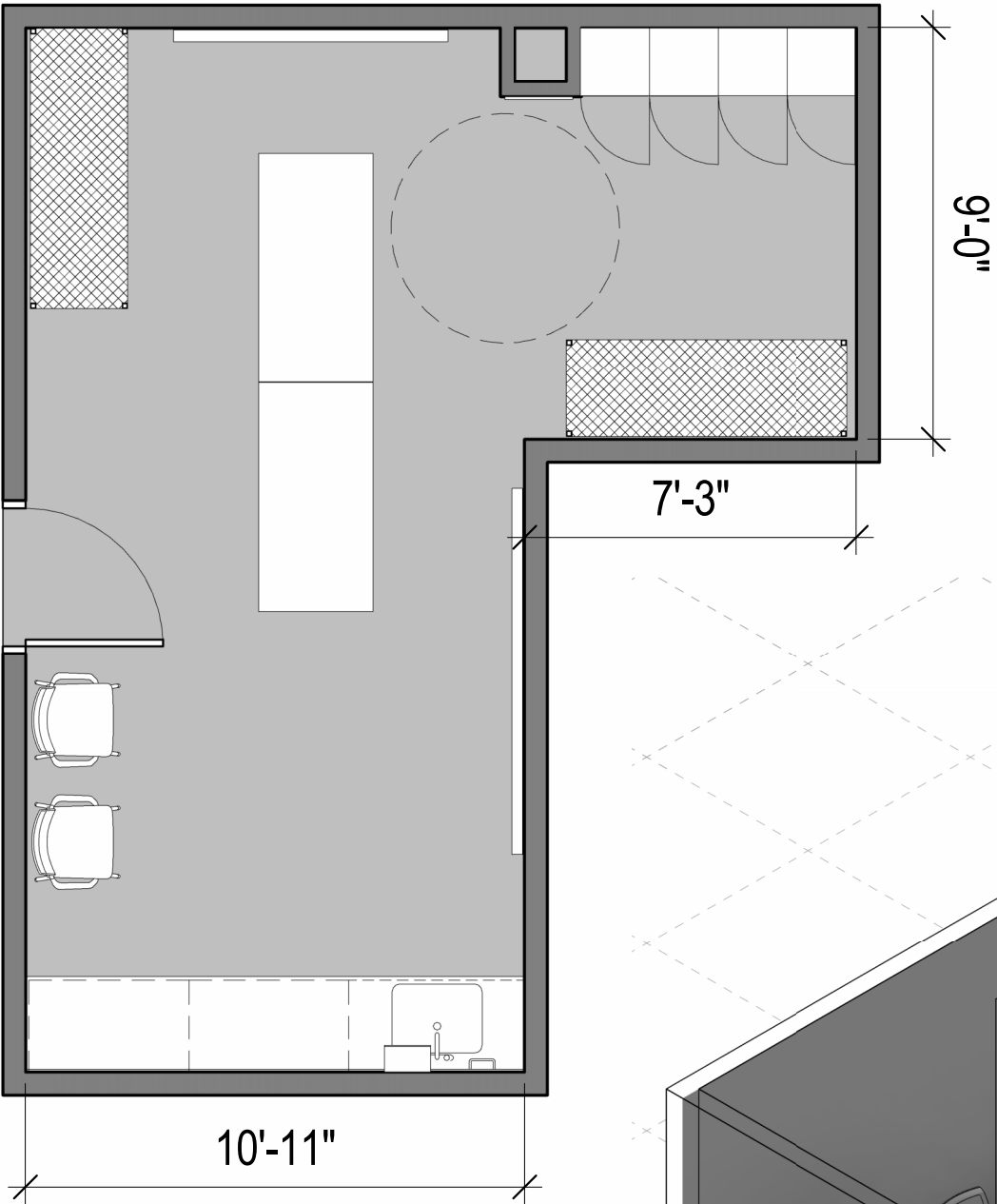

1 MAKER / MOULAGE
SCALE: 1/4" = 1'-0"

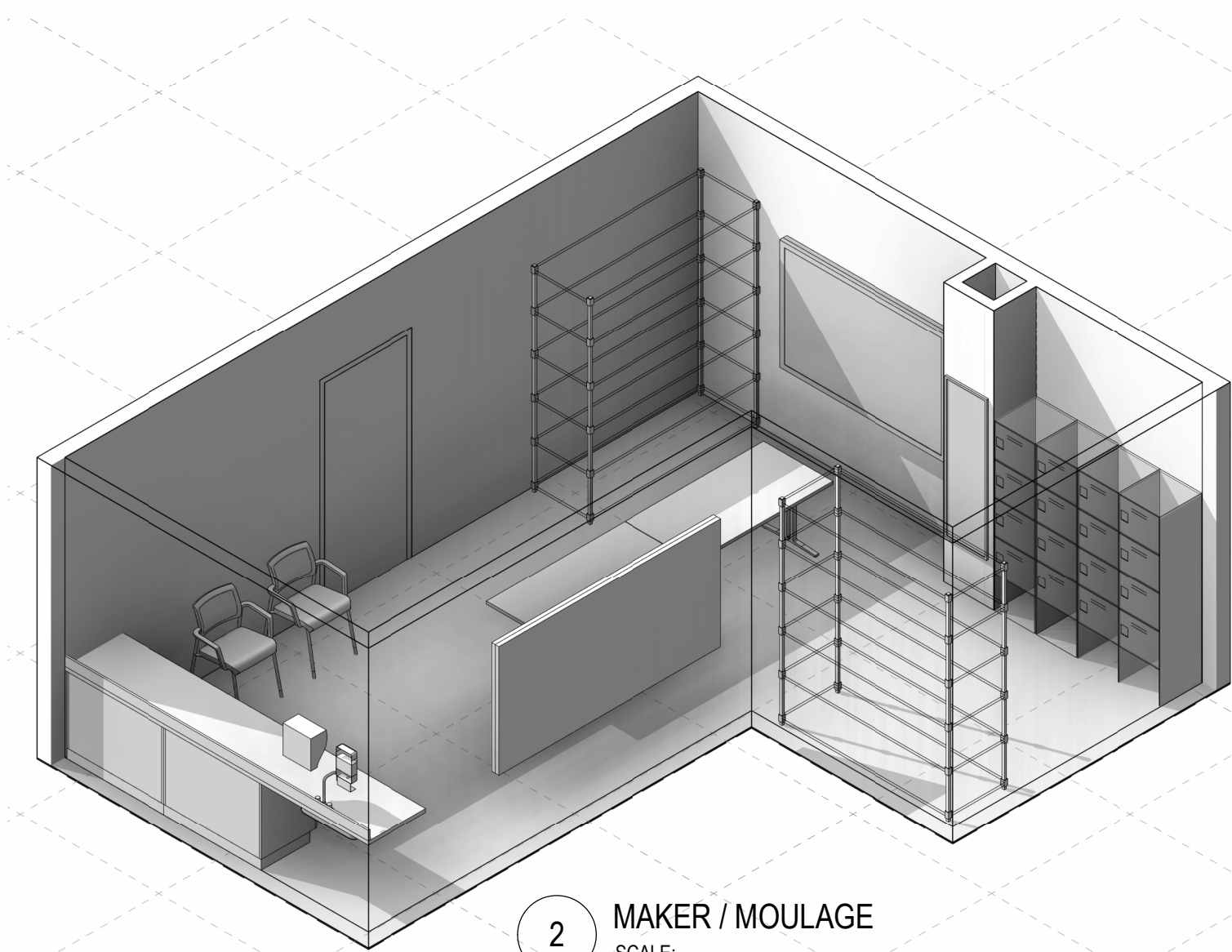

2 MAKER / MOULAGE
SCALE:

CODE	ANA.LAB-01
DESCRIPTION	VIRTUAL ANATOMY LAB (OPEN)
DEPARTMENT	INSTRUCTIONAL LAB
SPACE TYPE	INSTRUCTION LAB - CLINICAL SKILLS
GENERAL	
PROGRAM AREA (NSF)	200 SF
ACTUAL AREA. (NSF)	203 SF
PROGRAMED SEAT COUNT	4
FLOOR LOADING	
ACCESS	
ACOUSTICS	
SIGNAGE / WAYFINDING	
ELECTRONIC SECURITY	
SAFETY CONCERNS	
FINISHES (SEE PLANS)	
FLOORING	RESILIENT FLOORING (RF)
WALLS	PAINT (PT), WALL PROTECTION - RIGID SHEET (WP)
CEILING	ACOUSTIC TILE CEILING (CLG - ACT)
TECHNOLOGY REQMT	
EQUIPMENT, NETWORK, COMMUNICATIONS	
UTILITIES REQMT	
HVAC	
ELECTRICAL	
ELECTRIC LIGHT	SEE NOTE
PLUMBING	
ADD. REQUIREMENTS	
TOTAL QTY: (1)	

*Indicates items will not be part of the project Base pricing, listed for planning and design purposes ONLY.

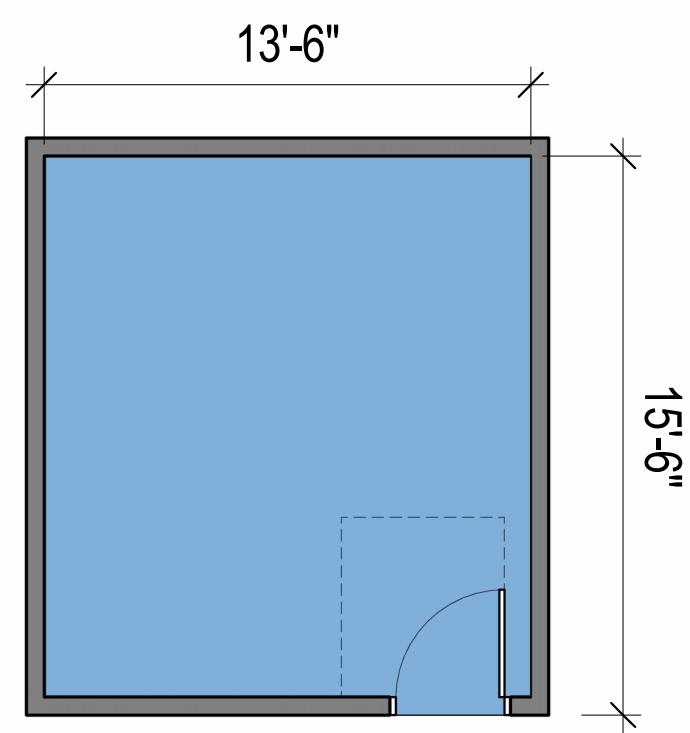

1 VIRTUAL ANATOMY LAB PLAN
SCALE: 3/16" = 1'-0"

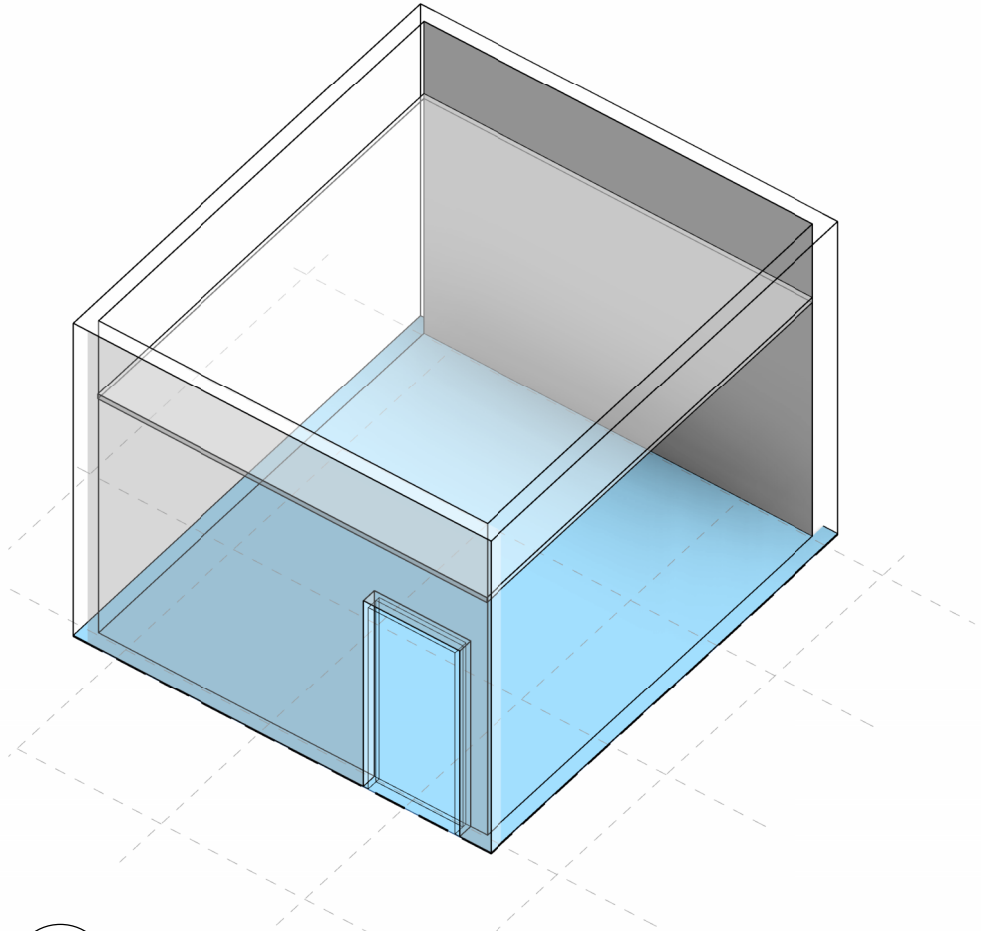

3 3D - VIRTUAL ANATOMY LAB
SCALE:

CODE	OFF-01, OFF-02, OFF-03
DESCRIPTION	OFFICE, PRIVATE
DEPARTMENT	OFFICE
SPACE TYPE	WORKPLACE
GENERAL	
PROGRAM AREA (NSF)	90 SF
ACTUAL AREA (NSF)	106 SF
PROGRAMED SEAT COUNT	1
FLOOR LOADING	
ACCESS	
ACOUSTICS	
SIGNAGE / WAYFINDING	
ELECTRONIC SECURITY	
SAFETY CONCERNS	
FINISHES (SEE PLANS)	
FLOORING	CARPET (CPT)
WALLS	PAINT (PT)
CEILING	ACOUSTIC TILE CEILING (CLG - ACT)
TECHNOLOGY REQMT	
EQUIPMENT, NETWORK, COMMUNICATIONS	
UTILITIES REQMT	
HVAC	
ELECTRICAL	
ELECTRIC LIGHT	RECESSED LENSED 2X2 ARCHITECTURAL TROFFER
PLUMBING	
ADD. REQUIREMENTS	
	TOTAL QTY: (8)

*Indicates items will not be part of the project Base pricing, listed for planning and design purposes ONLY.

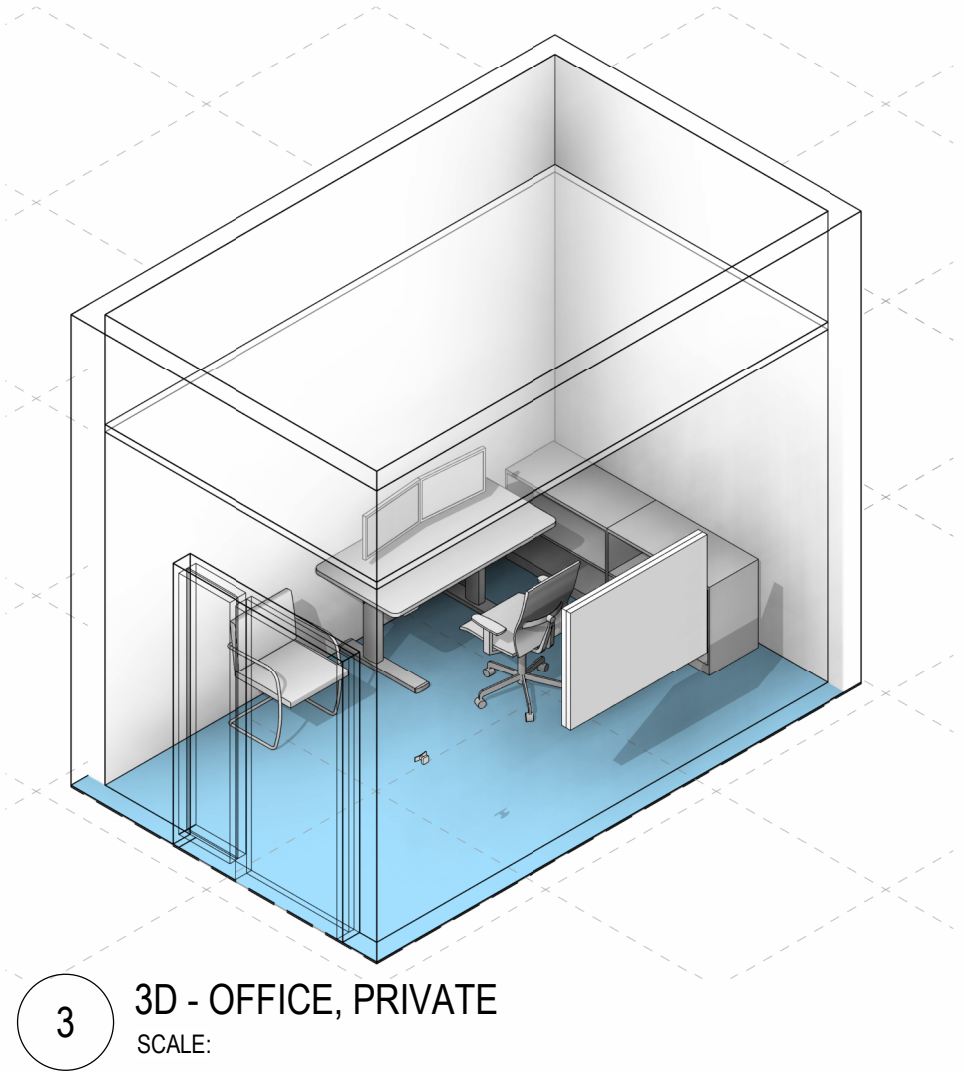
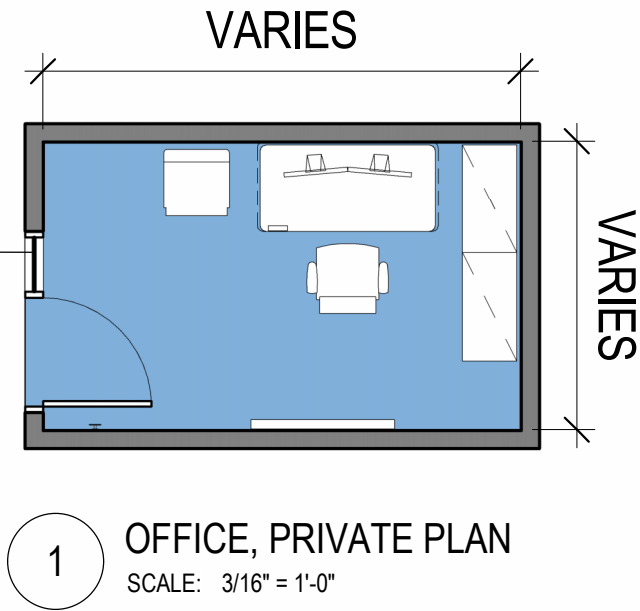

FFE Schedule - OFFICE, PRIVATE			Furniture Schedule - OFFICE, PRIVATE
FURNITURE FURNISHING AND EQUIPMENT TYPE	DESCRIPTION	COUNT	Furniture Seat Count

CODE	CTRL-02
DESCRIPTION	CONTROL ROOM, LARGE
DEPARTMENT	
SPACE TYPE	
GENERAL	
PROGRAM AREA (NSF)	400 SF
ACTUAL AREA, (NSF)	240 SF
PROGRAMED SEAT COUNT	1
FLOOR LOADING	
ACCESS	
ACOUSTICS	
SIGNAGE / WAYFINDING	
ELECTRONIC SECURITY	
SAFETY CONCERNS	
FINISHES (SEE PLANS)	
FLOORING	CARPET (CPT)
WALLS	PAINT (PT)
CEILING	ACOUSTIC TILE CEILING (CLG - ACT)
TECHNOLOGY REQMT	
EQUIPMENT, NETWORK, COMMUNICATIONS	
UTILITIES REQMT	
HVAC	
ELECTRICAL	
ELECTRIC LIGHT	RECESSED LENSED 2X2 ARCHITECTURAL TROFFER
PLUMBING	
ADD. REQUIREMENTS	
TOTAL QTY: (1)	

*Indicates items will not be part of the project Base pricing, listed for planning and design purposes ONLY.

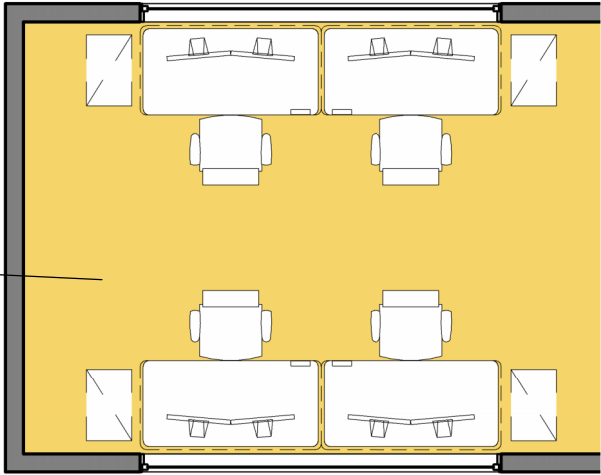

1 OFFICE, HOTELLING PLAN 1
SCALE: 3/16" = 1'-0"

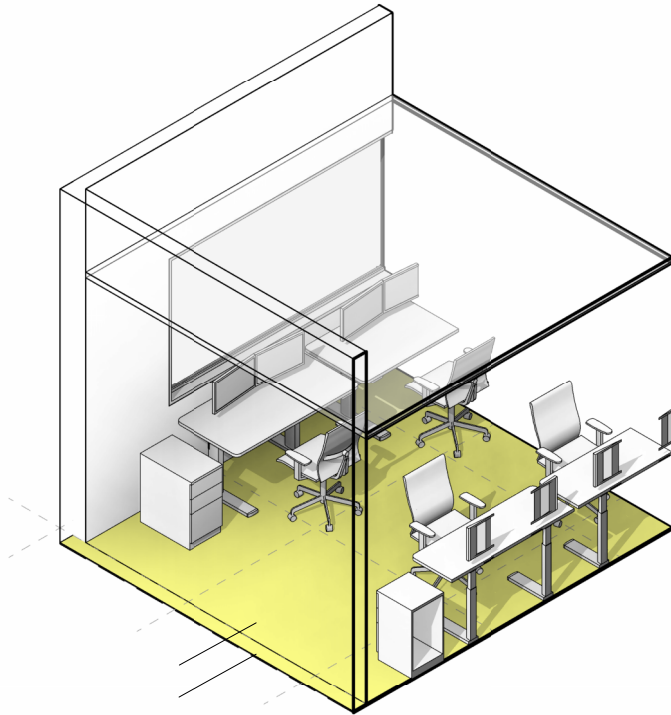

2 3D - OFFICE, HOTELLING 1
SCALE:

FFE Schedule - OFFICE, HOTELLING			Furniture Schedule - OFFICE, HOTELLING
FURNITURE FURNISHING AND EQUIPMENT TYPE	DESCRIPTION	COUNT	Furniture Seat Count

CODE	?
DESCRIPTION	?
DEPARTMENT	?
SPACE TYPE	?
GENERAL	
PROGRAM AREA (NSF)	?
ACTUAL AREA (NSF)	?
PROGRAMED SEAT COUNT	?
FLOOR LOADING	?
ACCESS	?
ACOUSTICS	?
SIGNAGE / WAYFINDING	?
ELECTRONIC SECURITY	?
SAFETY CONCERNS	?
FINISHES (SEE PLANS)	
FLOORING	?
WALLS	?
CEILING	?
TECHNOLOGY REQMT	?
EQUIPMENT, NETWORK, COMMUNICATIONS	?
UTILITIES REQMT	
HVAC	?
ELECTRICAL	?
ELECTRIC LIGHT	?
PLUMBING	?
ADD. REQUIREMENTS	
	?

*Indicates items will not be part of the project Base pricing, listed for planning and design purposes ONLY.

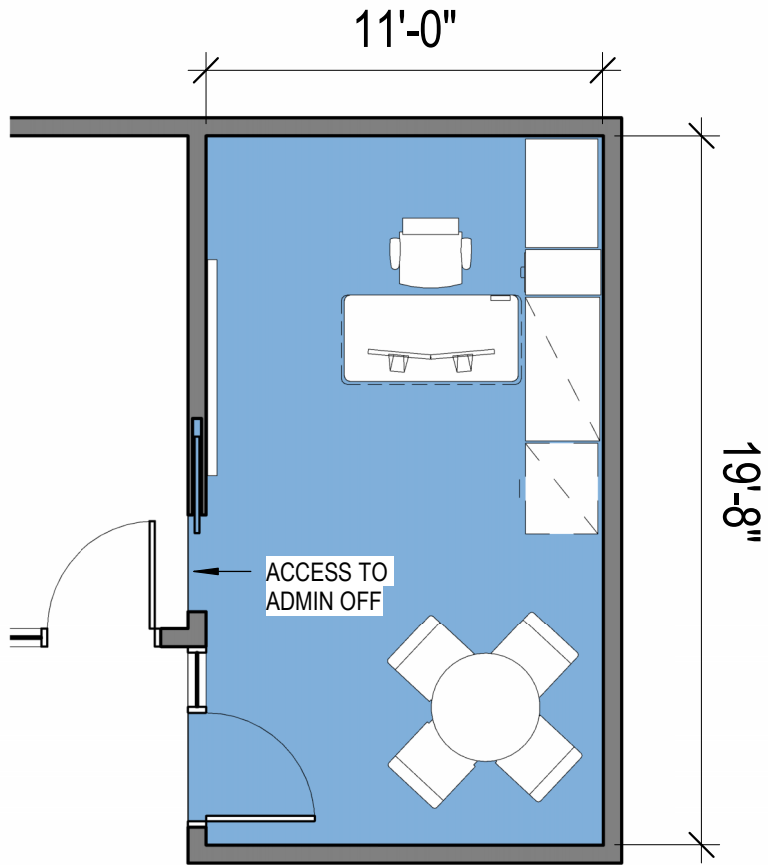

1 OFFICE - DIRECTOR PLAN
SCALE: 3/16" = 1'-0"

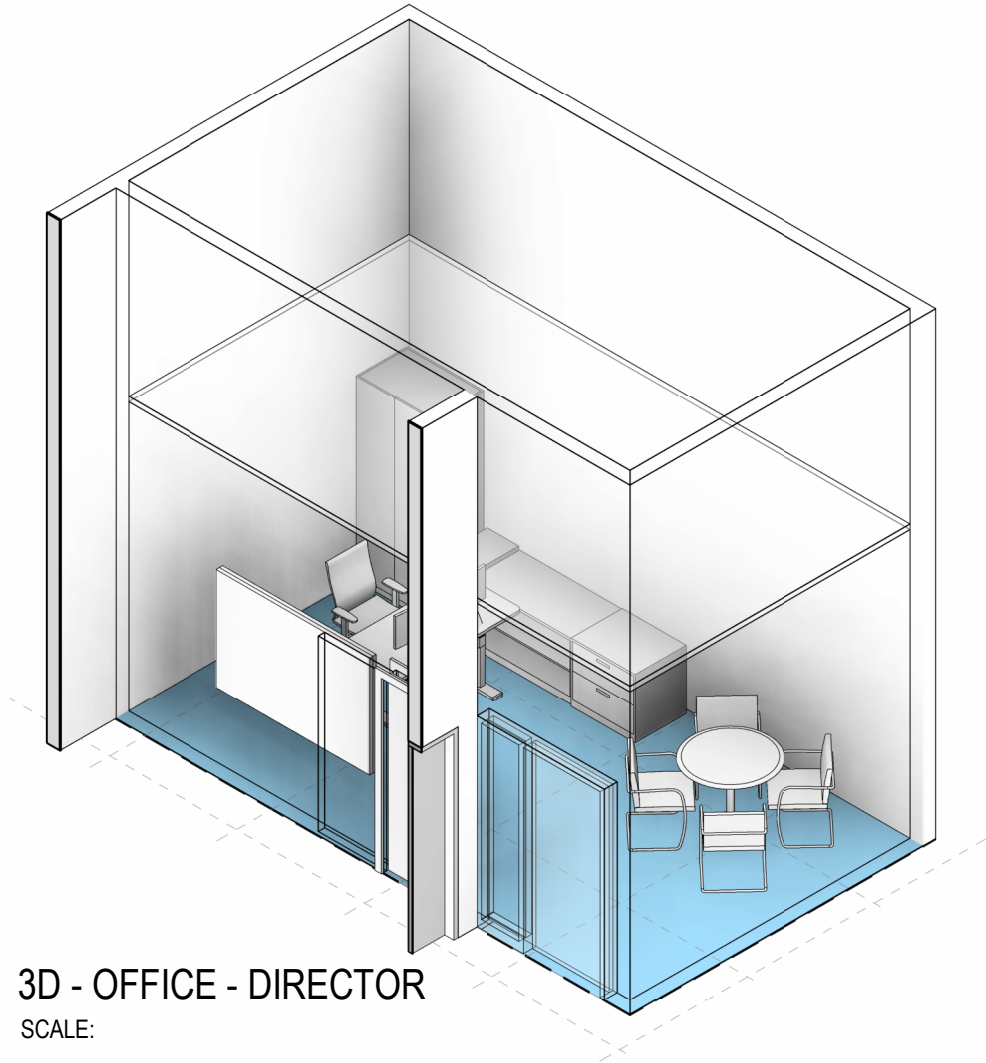

3 3D - OFFICE - DIRECTOR
SCALE:

FFE Schedule - OFFICE - DIRECTOR (120 SQFT)

FURNITURE FURNISHING AND EQUIPMENT TYPE	DESCRIPTION	COUNT
---	-------------	-------

Furniture Schedule - OFFICE - DIRECTOR (120 SQFT)

Furniture Seat Count

HEIGHT ADJUSTABLE DESK

CODE	?
DESCRIPTION	?
DEPARTMENT	?
SPACE TYPE	?
GENERAL	
PROGRAM AREA (NSF)	?
ACTUAL AREA, (NSF)	?
PROGRAMED SEAT COUNT	?
FLOOR LOADING	?
ACCESS	?
ACOUSTICS	?
SIGNAGE / WAYFINDING	?
ELECTRONIC SECURITY	?
SAFETY CONCERNS	?
FINISHES (SEE PLANS)	
FLOORING	?
WALLS	?
CEILING	?
TECHNOLOGY REQMT	?
EQUIPMENT, NETWORK, COMMUNICATIONS	?
UTILITIES REQMT	
HVAC	?
ELECTRICAL	?
ELECTRIC LIGHT	?
PLUMBING	?
ADD. REQUIREMENTS	
	?

*Indicates items will not be part of the project Base pricing, listed for planning and design purposes ONLY.

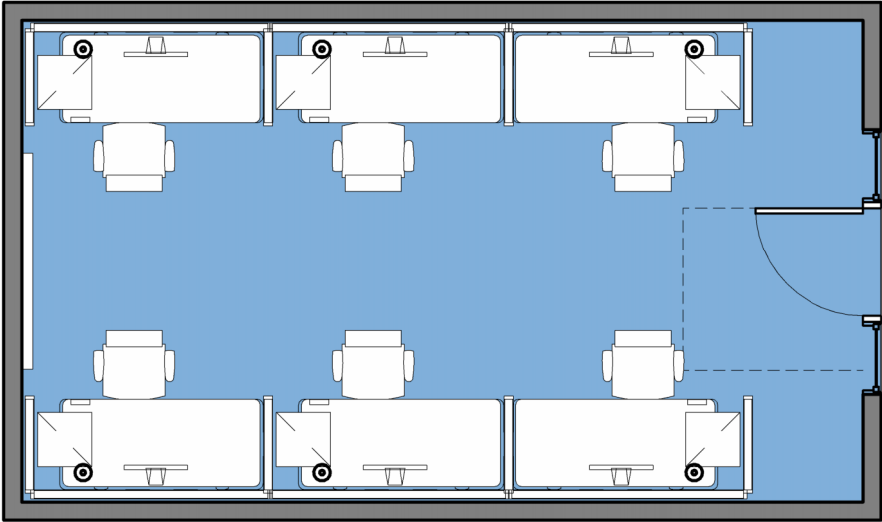

1 SIM OPS WORKSPACE
SCALE: 3/16" = 1'-0"

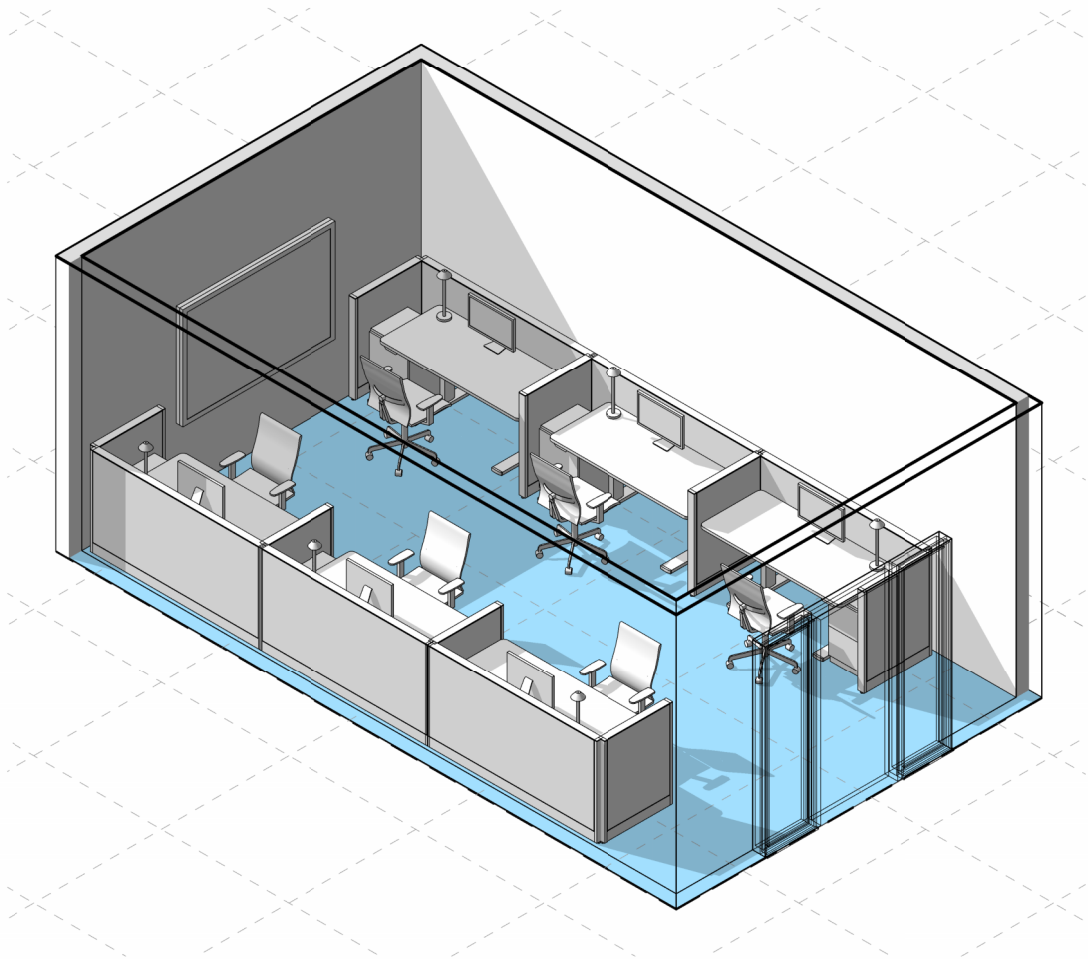

2 3D - SIM OPS WORKSPACE
SCALE:

FFE Schedule - COMBINED STUDENT OPEN WORKSPACE			Furniture Schedule - COMBINED STUDENT OPEN WORKSPACE
FURNITURE FURNISHING AND EQUIPMENT TYPE	DESCRIPTION	COUNT	Furniture Seat Count

CODE	LNG-01
DESCRIPTION	STAFF LOUNGE
DEPARTMENT	OFFICE
SPACE TYPE	WORKPLACE
GENERAL	
PROGRAM AREA (NSF)	300 SF
ACTUAL AREA. (NSF)	394 SF
PROGRAMED SEAT COUNT	12
FLOOR LOADING	
ACCESS	
ACOUSTICS	
SIGNAGE / WAYFINDING	
ELECTRONIC SECURITY	
SAFETY CONCERNS	
FINISHES (SEE PLANS)	
FLOORING	RESILIENT FLOORING (RF)
WALLS	PAINT (PT), ACOUSTIC FABRIC WRAPPED PANEL (FWP), WOOD VENEER (WD)
CEILING	GYPSUM BOARD CEILING (CLG - GYB)
TECHNOLOGY REQMT	
EQUIPMENT, NETWORK, COMMUNICATIONS	
UTILITIES REQMT	
HVAC	
ELECTRICAL	
ELECTRIC LIGHT	
PLUMBING	
ADD. REQUIREMENTS	
	TOTAL QTY: (1)

*Indicates items will not be part of the project Base pricing, listed for planning and design purposes ONLY.

NOTE:
RECESSED DOWN LIGHT AREA LIGHTING,RECESSED
WALL WASH ACCENT LIGHTING, PENDANT MOUNTED
FIXED FURNITURE LIGHTING, UNDER CABINET TASK
LIGHTING.

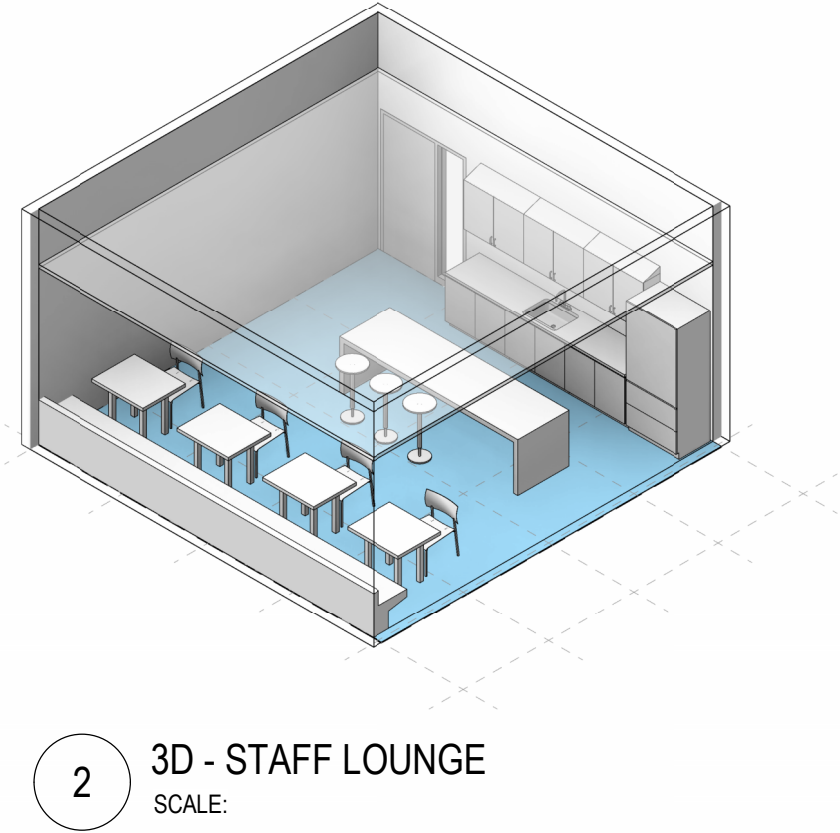
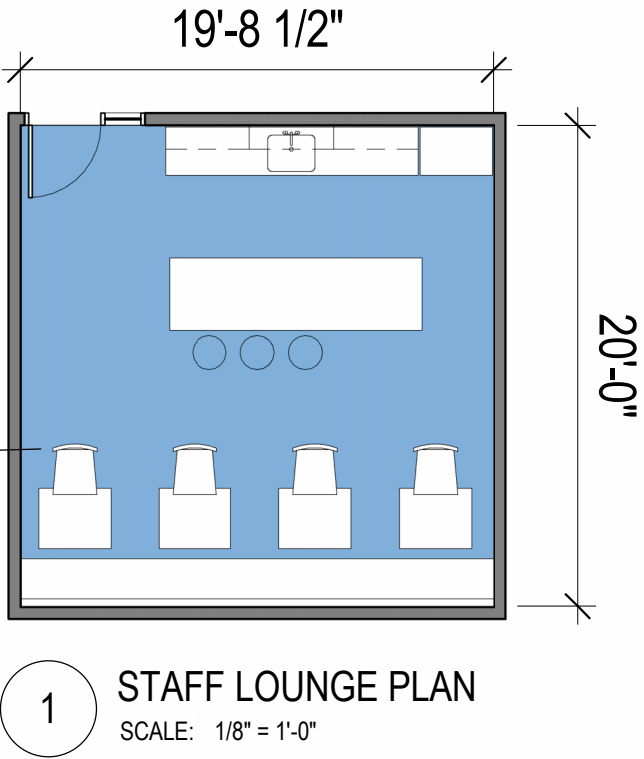

FFE Schedule - STAFF LOUNGE			Furniture Schedule - STAFF LOUNGE
FURNITURE FURNISHING AND EQUIPMENT TYPE	DESCRIPTION	COUNT	Furniture Seat Count

CODE	COPY
DESCRIPTION	WORK / COPY
DEPARTMENT	PREP CLINIC (1), PHLEBOTOMY (1), COMP. PHARM (1)
SPACE TYPE	
GENERAL	
PROGRAM AREA (NSF)	100 SF
ACTUAL AREA. (NSF)	92 SF
PROGRAMED SEAT COUNT	1
FLOOR LOADING	
ACCESS	
ACOUSTICS	
SIGNAGE / WAYFINDING	
ELECTRONIC SECURITY	
SAFETY CONCERNS	
FINISHES (SEE PLANS)	
FLOORING	CARPET (CPT)
WALLS	PAINT (PT)
CEILING	ACOUSTIC TILE CEILING (CLG - ACT)
TECHNOLOGY REQMT	
EQUIPMENT, NETWORK, COMMUNICATIONS	
UTILITIES REQMT	
HVAC	
ELECTRICAL	
ELECTRIC LIGHT	
PLUMBING	
ADD. REQUIREMENTS	
	T QTY: (1)

*Indicates items will not be part of the project Base pricing, listed for planning and design purposes ONLY.

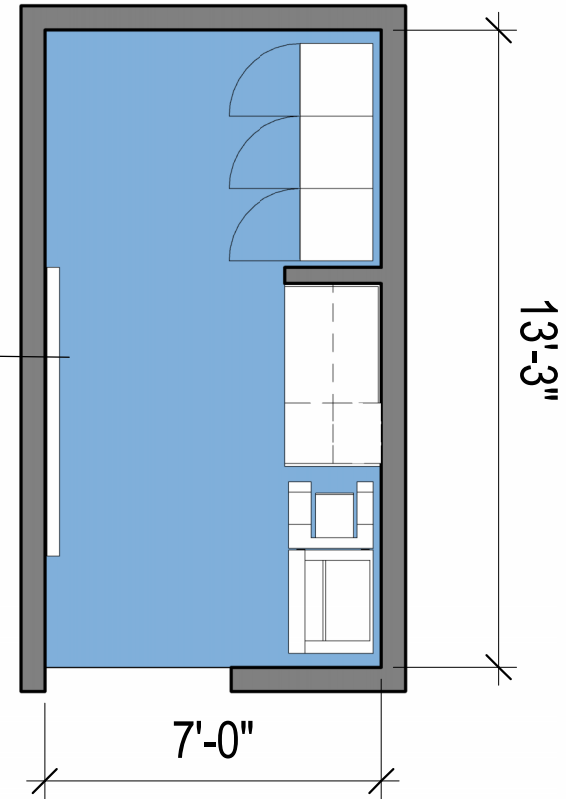

1 WORK / COPY
SCALE: 1/4" = 1'-0"

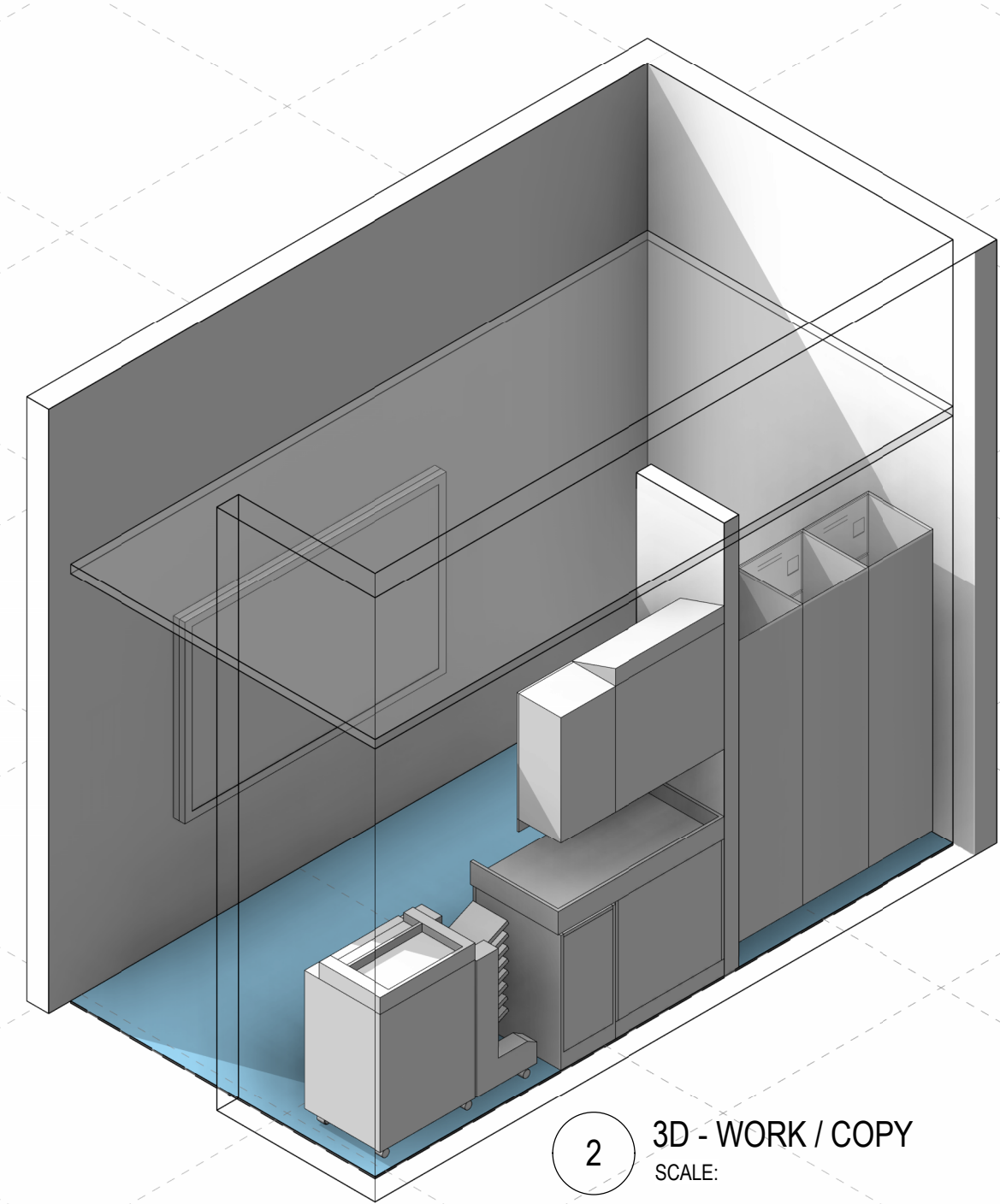

2 3D - WORK / COPY
SCALE:

FFE Schedule - WORK / COPY		
FURNITURE FURNISHING AND EQUIPMENT TYPE	DESCRIPTION	COUNT

CODE	LNG-02
DESCRIPTION	KITCHENETTE BREAKROOM / LOUNGE
DEPARTMENT	GENERAL USE
SPACE TYPE	RECEPTION
GENERAL	
PROGRAM AREA (NSF)	400 SF
ACTUAL AREA (NSF)	398 SF
PROGRAMED SEAT COUNT	12
FLOOR LOADING	
ACCESS	
ACOUSTICS	
SIGNAGE / WAYFINDING	
ELECTRONIC SECURITY	
SAFETY CONCERNS	
FINISHES (SEE PLANS)	
FLOORING	RESILIENT FLOORING (RF)
WALLS	PAINT (PT), ACOUSTIC FABRIC WRAPPED PANEL (FWP), WOOD VENEER (WD)
CEILING	GYPSUM BOARD CEILING (CLG - GYB)
TECHNOLOGY REQMT	
EQUIPMENT, NETWORK, COMMUNICATIONS	
UTILITIES REQMT	
HVAC	
ELECTRICAL	
ELECTRIC LIGHT	SEE NOTE
PLUMBING	
ADD. REQUIREMENTS	
TOTAL QTY: (1)	

*Indicates items will not be part of the project Base pricing, listed for planning and design purposes ONLY.

NOTE:
RECESSED DOWN LIGHT AREA LIGHTING,RECESSED
WALL WASH ACCENT LIGHTING, PENDANT MOUNTED
FIXED FURNITURE LIGHTING, UNDER CABINET TASK
LIGHTING.

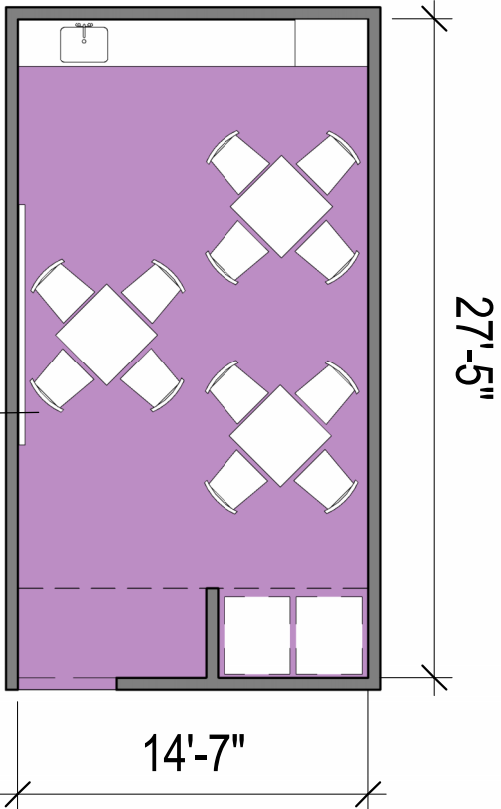

1 BREAKROOM/LOUNGE PLAN
SCALE: 1/8" = 1'-0"

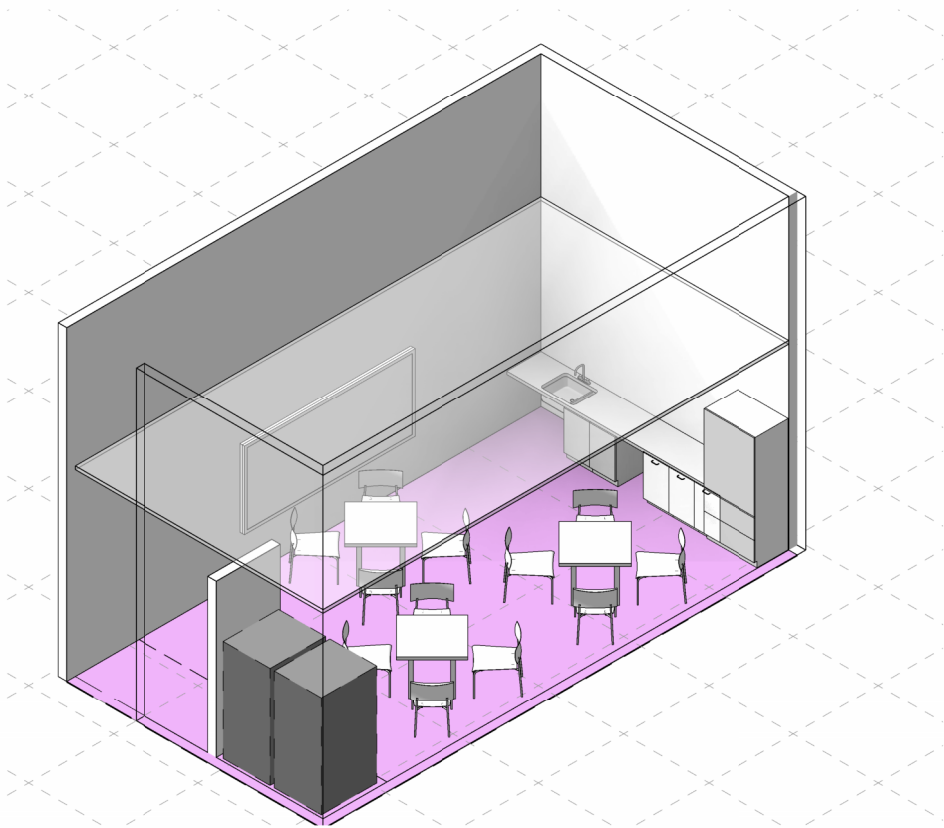

3 3D - KITCHENETTE/BREAKROOM/LOUNGE
SCALE:

FFE Schedule - KITCHENETTE / BREAKROOM / LOUNGE			Furniture Schedule - KITCHENETTE / BREAKROOM / LOUNGE
FURNITURE FURNISHING AND EQUIPMENT TYPE	DESCRIPTION	COUNT	Furniture Seat Count

CODE	WEL/LAC-01
DESCRIPTION	WELLNESS / LACTATION ROOM
DEPARTMENT	GENERAL USE
SPACE TYPE	RECEPTION
GENERAL	
PROGRAM AREA (NSF)	110 SF
ACTUAL AREA (NSF)	95 SF
PROGRAMED SEAT COUNT	1
FLOOR LOADING	
ACCESS	
ACOUSTICS	
SIGNAGE / WAYFINDING	
ELECTRONIC SECURITY	
SAFETY CONCERNS	
FINISHES (SEE PLANS)	
FLOORING	CARPET (CPT)
WALLS	PAINT (PT)
CEILING	GYPSUM BOARD CEILING (CLG - GYB)
TECHNOLOGY REQMT	
EQUIPMENT, NETWORK, COMMUNICATIONS	
UTILITIES REQMT	
HVAC	
ELECTRICAL	
ELECTRIC LIGHT	RECESSED LENSED ARCHITECTURAL 2X2
PLUMBING	
ADD. REQUIREMENTS	
	TOTAL QTY: (1)

*Indicates items will not be part of the project Base pricing, listed for planning and design purposes ONLY.

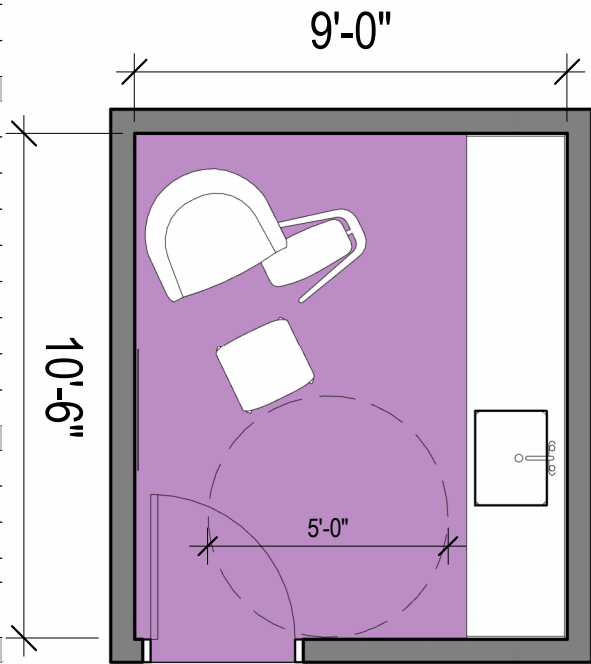

1 WELLNESS/LACTATION ROOM PLAN
SCALE: 1/4" = 1'-0"

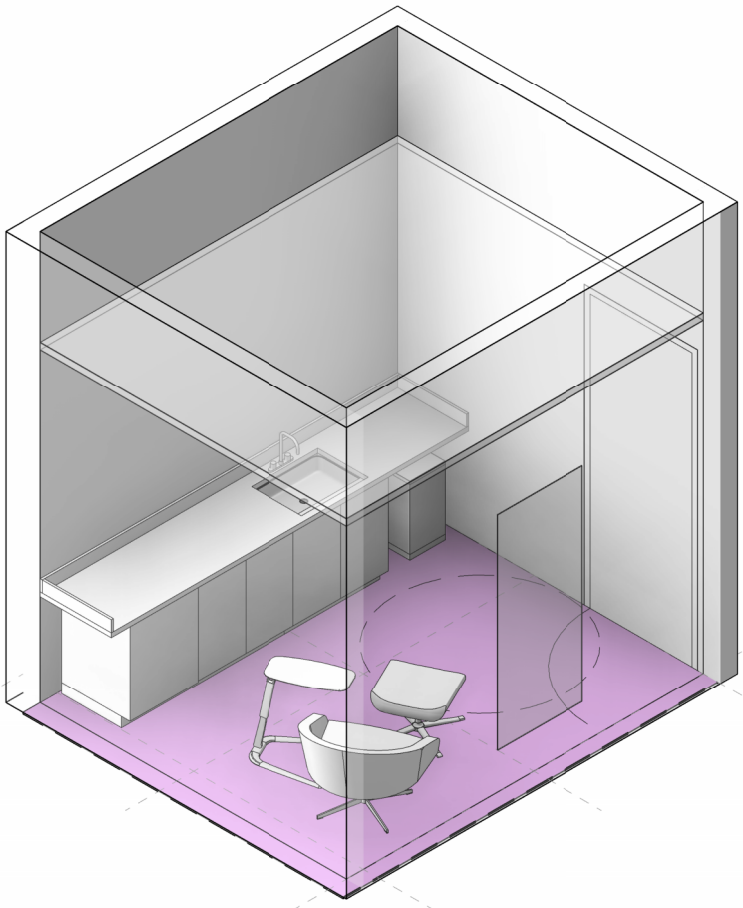

3 3D - WELLNESS/LACTATION ROOM
SCALE:

FFE Schedule - WELLNESS / LACTATION ROOM			Furniture Schedule - WELLNESS / LACTATION ROOM
FURNITURE FURNISHING AND EQUIPMENT TYPE	DESCRIPTION	COUNT	Furniture Seat Count

CODE	?
DESCRIPTION	?
DEPARTMENT	?
SPACE TYPE	?
GENERAL	
PROGRAM AREA (NSF)	?
ACTUAL AREA. (NSF)	?
PROGRAMED SEAT COUNT	?
FLOOR LOADING	?
ACCESS	?
ACOUSTICS	?
SIGNAGE / WAYFINDING	?
ELECTRONIC SECURITY	?
SAFETY CONCERNS	?
FINISHES (SEE PLANS)	
FLOORING	?
WALLS	?
CEILING	?
TECHNOLOGY REQMT	?
EQUIPMENT, NETWORK, COMMUNICATIONS	?
UTILITIES REQMT	
HVAC	?
ELECTRICAL	?
ELECTRIC LIGHT	?
PLUMBING	?
ADD. REQUIREMENTS	
	?

*Indicates items will not be part of the project Base pricing, listed for planning and design purposes ONLY.

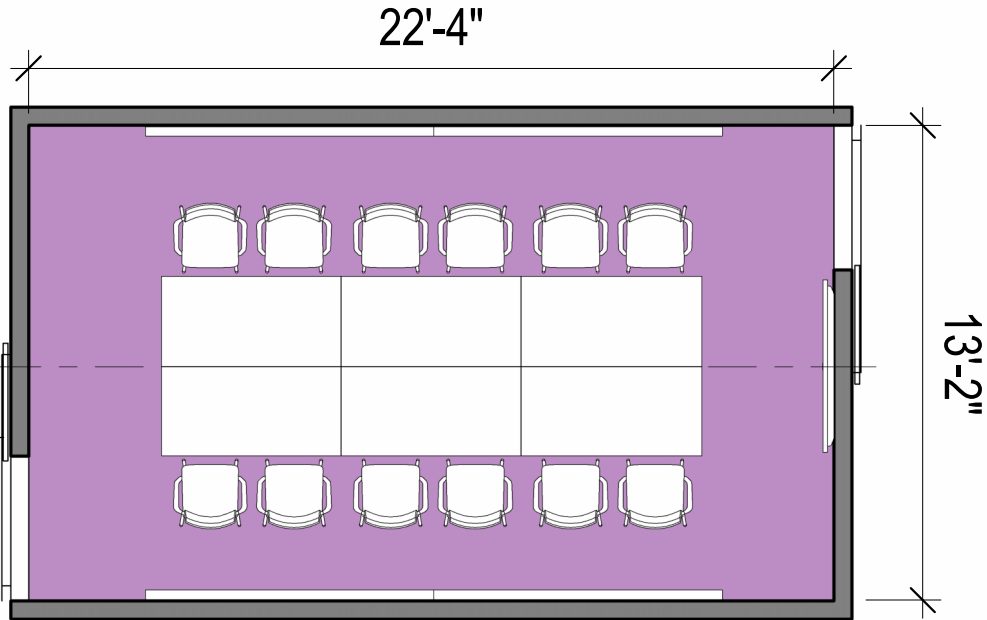

1 MED CONFERENCE ROOM PLAN
SCALE: 3/16" = 1'-0"

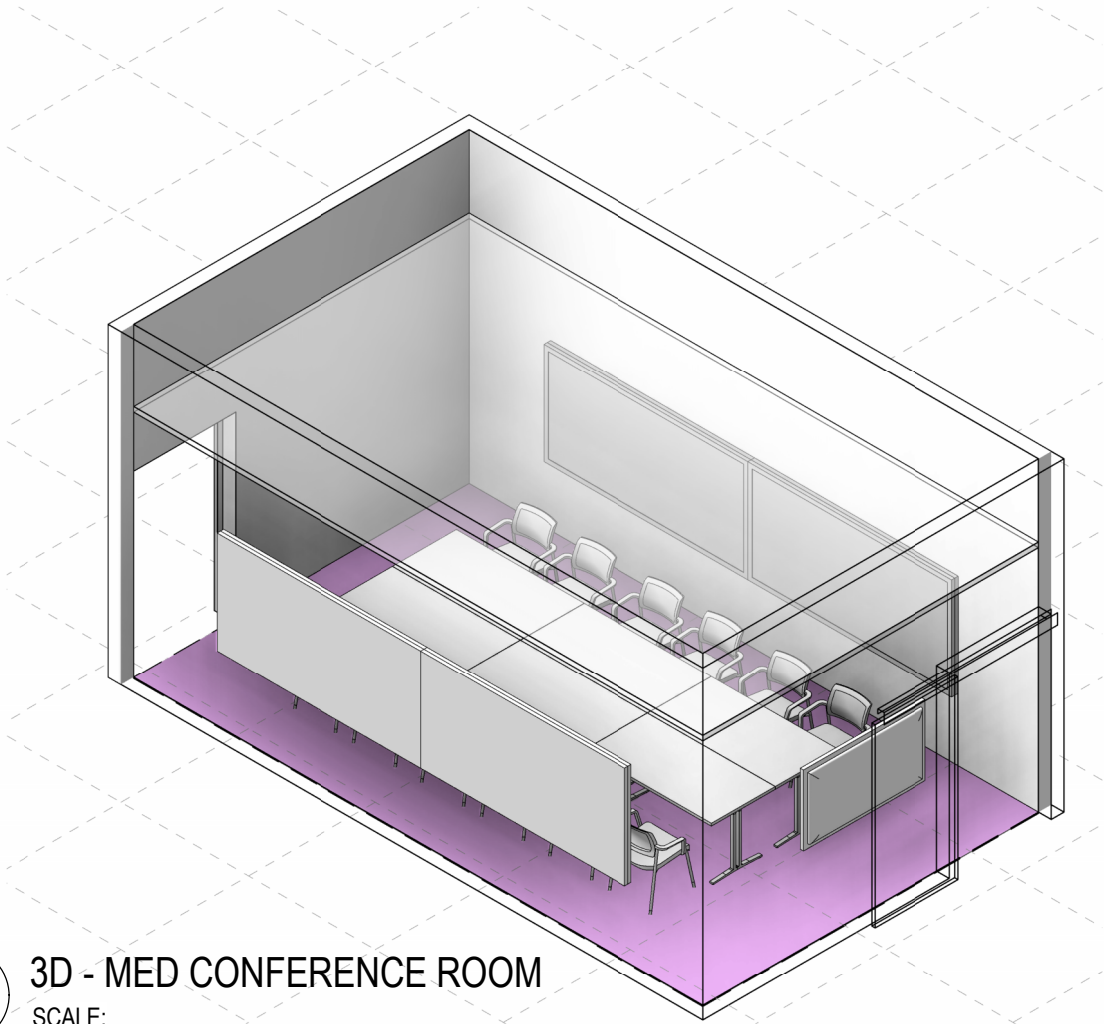

3 3D - MED CONFERENCE ROOM
SCALE:

FFE Schedule - MEDIUM CONFERENCE ROOM			Furniture Schedule - MEDIUM CONFERENCE ROOM
FURNITURE FURNISHING AND EQUIPMENT TYPE	DESCRIPTION	COUNT	Furniture Seat Count

CODE	CNF.5
DESCRIPTION	SMALL MEETING ROOM / HUDDLE
DEPARTMENT	GENERAL USE
SPACE TYPE	ASSEMBLY/MEETING
GENERAL	
PROGRAM AREA (NSF)	120 SF
ACTUAL AREA. (NSF)	143 SF
PROGRAMED SEAT COUNT	4
FLOOR LOADING	
ACCESS	
ACOUSTICS	
SIGNAGE / WAYFINDING	
ELECTRONIC SECURITY	
SAFETY CONCERNS	
FINISHES (SEE PLANS)	
FLOORING	CARPET (CPT)
WALLS	PAINT (PT), ACOUSTIC FABRIC WRAPPED PANEL (FWP)
CEILING	ACOUSTIC TILE CEILING (CLG - ACT)
TECHNOLOGY REQMT	
EQUIPMENT, NETWORK, COMMUNICATIONS	
UTILITIES REQMT	
HVAC	
ELECTRICAL	
ELECTRIC LIGHT	PENDANT MOUNTED BAFFLED LINER DIRECT/INDIRECT AREA LIGHTING, RECESSED LINEAR WALL WASH
PLUMBING	
ADD. REQUIREMENTS	
	T QTY: (2)

*Indicates items will not be part of the project Base pricing, listed for planning and design purposes ONLY.

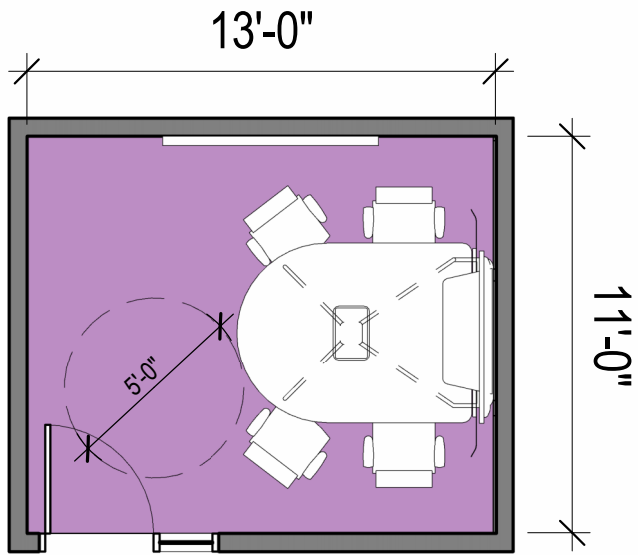

1 SMALL MEETING/HUDDLE PLAN
SCALE: 3/16" = 1'-0"

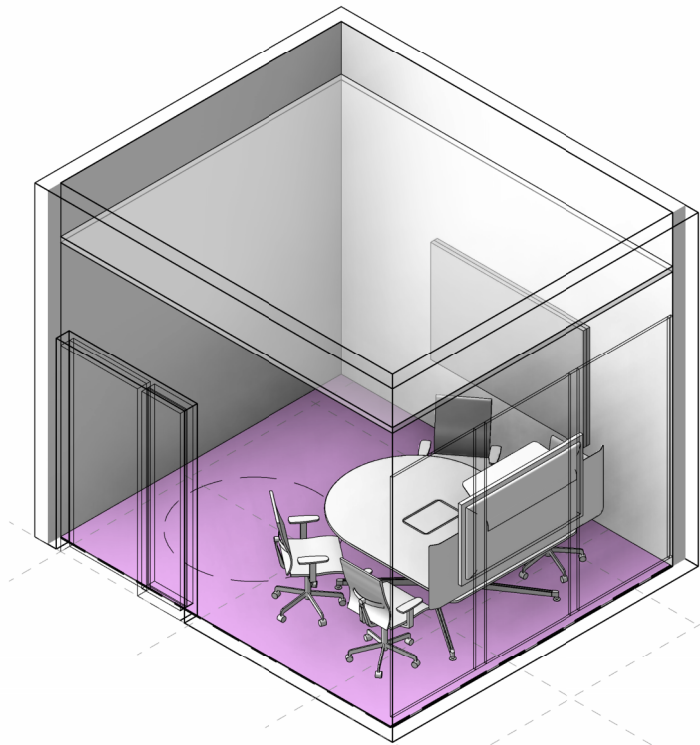

3 3D - SMALL MEETING/HUDDLE
SCALE:

FFE Schedule - SMALL MEETING ROOM / HUDDLE			Furniture Schedule - SMALL MEETING ROOM / HUDDLE	
FURNITURE FURNISHING AND EQUIPMENT TYPE	DESCRIPTION	COUNT	Furniture Seat Count	
DOOR-Hinged-SGL-sgl SideLight: 36 X 84 - 18		1	4	
FURN-Chair-Task: Task-Arm		4		
FURN-Table-Dshape: Dual-Monitor		1		
FURN-White Board-Tack Board: 72"x48"		1		

